

Introduced September 27, 1988, by  
Councilman Van Sandt, seconded by  
Councilman-at-Large Singletary  
(both by request)

Item No. 88-09-1296

ORDINANCE NO. 2212

An ordinance authorizing the Mayor or his designated representatives to negotiate and acquire servitudes for public works projects.

WHEREAS, it is frequently necessary for the City to acquire servitudes over private property to construct public works projects, and

WHEREAS, Section 2-10 of the City Charter requires that an ordinance be enacted to acquire real property on behalf of the City; and

WHEREAS, the acquisition of a servitude could be considered the acquisition of real property; and

WHEREAS, it is frequently necessary for the City to negotiate and acquire servitudes within a short period of time; and

WHEREAS, the enactment of an ordinance in each instance would delay public projects,

NOW, THEREFORE, BE IT ORDAINED that the Mayor or his authorized representative is hereby authorized to negotiate servitudes on behalf of the City.

BE IT FURTHER ORDAINED that the Mayor is authorized to acquire servitudes on behalf of the City without further authorization from the Council provided that the cost of the servitude does not exceed \$3,000.00 and further provided that the owner of the property is not an employee or public official of the City government;

BE IT FURTHER CRDAINED that any acquisition of servitudes by the City prior to the effective date of this ordinance are hereby ratified.

ADOPTED this 25th day of October, 1988.

CERTIFIED  
TRUE COPY

DELIVERED 10/27/88

9:00 A.M. to the Mayor

RECEIVED 10/31/88

11:00 A.M. from the Mayor

*Richard B. Van Sandt*  
Council Administrator/  
of the Council  
Richard B. Van Sandt  
Councilman, District C  
President of the Council

*Salvatore A. Caruso*  
Salvatore A. Caruso  
Mayor

*Davis Dautreuil*  
Davis Dautreuil  
Council Administrator/Clerk of the Council

2212  
RECEIVED  
MAR 8 1997  
COUNCIL'S OFFICE

# MEMORANDUM

FROM TIM MATHISON, CITY ATTORNEY

TO: Reinhard J. Dearing, Chief of Staff  
Forrest Koder, Planning Department  
Sharon Howes, Finance Director  
Davis Dautreuil, Council Admin./Clerk of the Council  
Stanley P. Polivick, PE, City Engineer

DATE: March 6, 1997

RE: ROW Acquisition  
OST/Fremaux Water Line Extension  
84 Lumber Company, n/k/a The Magerko Corp.  
Slidell Job #200-28  
File No. 96-C-0019

Attached is a copy of the fully executed servitude granted to the City of Slidell by 84 Lumber Company, n/k/a The Magerko Corp. The servitude was recorded with the Clerk of Court in Covington on February 6, 1997, Instrument # 1033551.

TM/jkf  
Attachment

GRANT OF UTILITY SERVITUDE

STATE OF LOUISIANA

BY: 84 LUMBER COMPANY

PARISH OF ST. TAMMANY

TO: CITY OF SLIDELL, LOUISIANA

KNOW ALL MEN BY THESE PRESENTS, that:

84 LUMBER COMPANY, <sup>N/K/A The Magerko Corporation</sup> a Pennsylvania Corporation, duly authorized to do business in the State of Louisiana,

(hereinafter OWNER),

AND

THE CITY OF SLIDELL (hereinafter CITY), a municipal corporation of the State of Louisiana, represented herein by its Mayor, Salvatore A. Caruso, duly authorized by ordinance of the Slidell City Council, the governing authority thereof, Ordinance Number 2212 dated October 25, 1988, which entity has a permanent mailing address of P. O. Box 828, 2055 Second Street, Slidell, Louisiana 70459,

declare that OWNER does hereby grant to CITY the following described RIGHT-OF-WAY:

An easement for utility purposes situated in Plot F, Kingspoint Subdivision, Section 5, which is in Section 23, Township 9 South, Range 14 East, St. Tammany Parish, Louisiana more fully described as follows:

At the most south westerly property corner on the I-10 Service Road proceed North 17 degrees, 10 minutes, 07 seconds East 173.49 feet to a point;

Thence North 89 degrees, 10 minutes, 07 seconds East 10 feet to a point;

Thence South 17 degrees, 10 minutes, 07 seconds West 173.49 feet to a point;

Thence South 89 degrees, 10 minutes, 07 seconds West 10 feet to the Point of Beginning.

Containing in all  $\pm$  1734.9 square feet.

within which to lay, maintain, inspect, operate, repair, alter, remove and relay utility lines for transportation of sewerage and water and such drips, valves, fittings, meters, manholes, and other equipment and appurtenances as may be necessary or convenient for such operations across and under the following described property, to-wit:

ALL THAT CERTAIN PIECE OR PARCEL OF LAND, together with all buildings and improvements thereon, situated in St. Tammany Parish, Louisiana and more fully described as follows, to-wit:

2.396 ACRES OF LAND, more or less situated in PLOT F, KINGSPOINT SUBDIVISION, SECTION 5, which is in Section 23, Township 9 South, Range 14 East, St. Tammany Parish, Louisiana.

All in accordance with parcel outlined in blue on Survey Map by Borgen Engineering, Survey No. 19194 dated January 15, 1979.

Acquired by St. Tammany Land Holders, Inc. from James E. Morrison, et al on January 29, 1979 and recorded in COB 919 folio 772, records of St. Tammany Parish, Louisiana.

DT. REG # 713,417  
Inst # 1033551  
FILED ST. TAMMANY PAR  
02/06/1997 08:30:00AM kst  
COB\_X\_ MOB\_\_\_ MI\_\_\_

ALSO DESCRIBED AS FOLLOWS:

ALL THAT CERTAIN PARCEL OF LAND being situated in part of PLOT F in KINGSPPOINT SUBDIVISION, SECTION 5, located in Section 23, Township 9 South, Range 14 East, St. Tammany Parish, Louisiana, being more fully described as follows:

Commencing from the Section corner common to Sections 14, 13, 23 and 24 in said Township and Range, thence South 00 degrees, 48 minutes, 20 seconds East 55.25 feet to a point; thence South 89 degrees, 21 minutes, 44 seconds West 1233.11 feet to a point; thence South 00 degrees, 38 minutes, 16 seconds East 435.35 feet to the point of beginning.

Thence from the point of beginning continue South 00 degrees, 38 minutes, 16 seconds East 102.69 feet to a point; thence South 62 degrees, 19 minutes, 06 seconds West 137.96 feet to a point; thence South 89 degrees, 10 minutes, 07 seconds West 560.50 feet to the Eastern Right-of-Way line of Interstate 10 Service Road; thence along said Eastern Right-of-Way line North 17 degrees, 10 minutes, 07 seconds East 173.49 feet to a point; thence North 89 degrees, 10 minutes, 07 seconds East 630.32 feet to the point of beginning.

Containing in all 2.40 acres of land, more or less.

All in accordance with Survey No. 24,912 dated September 10, 1980 by Borgen Engineering.

Together with all rights of ingress and egress to and from the line or lines, or any of them, for the purposes and benefits aforesaid. OWNER shall have the right to fully use and enjoy the above described property, except as to the rights hereinabove granted. CITY hereby agrees and obligates itself to pay any damages which may occur to fences, buildings or other property of the OWNER as a result of the exercise of the rights herein granted.

This servitude is made for and in consideration of the price and sum of FIVE HUNDRED AND NO/100 (\$500.00) DOLLARS and other valuable considerations, cash in hand paid, the receipt of which is hereby acknowledged and full acquittance and discharge therefor given and future advantages and benefits.

THUS DONE AND PASSED on the 9th day of JANUARY, 1997, in the presence of the undersigned witnesses, who hereunto sign their names with the said appearer and me, Notary, after reading of the whole.

WITNESSES:

84 LUMBER COMPANY N/K/A The Magerko Corporation

Cheri B. Bannan

BY: Joseph [Signature]

Vincent D. Bobrowski

Mary E. Saniga  
Notary Public

Notarial Seal  
Mary E. Saniga, Notary Public  
Peters Twp., Washington County  
My Commission Expires Aug. 31, 1998  
Member, Pennsylvania Association of Notaries

THUS DONE AND PASSED on the 23rd day of January, 1997,  
in the presence of the undersigned witnesses, who hereunto sign  
their names with the said appearer and me, Notary, after reading of  
the whole.

WITNESSES:

CITY OF SLIDELL, LOUISIANA

Jackie K. Tradella

Wanda Brudgema

BY:

Salvatore A. Caruso  
SALVATORE A. "SAM" CARUSO  
Mayor

Tim Mathison  
TIM MATHISON, Notary Public  
City of Slidell  
P. O. Box 828  
Slidell, LA 70459  
(504) 646-4396

*file* *Ord 2212*  
**MEMORANDUM**

**FROM TIM MATHISON, CITY ATTORNEY**

**JUN 7 1996**

**COUNCIL'S OFFICE**

TO: Reinhard J. Dearing, Chief of Staff  
Forrest Koder, Planning Department  
Sharon Howes, Finance Director  
Davis Dautreuil, Council Admin./Clerk of the Council  
Stanley P. Polivick, PE, City Engineer

DATE: June 6, 1996

RE: Riviera Drive Drainage Project

Attached are copies of the fully executed servitudes granted to the City of Slidell by Virginia Nell, Kathy Quirk and Charles Landry. The servitudes were recorded with the Clerk of Court in Covington on May 28, 1996, Instrument # 998090, 998092 and 998086.

/j kf *Map*  
Attachment

*file w/ord on project*

GRANT OF DRAINAGE SERVITUDE

STATE OF LOUISIANA

BY: VIRGINIA L. NELL

PARISH OF ST. TAMMANY

TO: CITY OF SLIDELL, LOUISIANA

KNOW ALL MEN BY THESE PRESENTS, that on the 23rd day of April, 1996,

VIRGINIA L. NELL, a person of the full age of majority, domiciled in the Parish of St. Tammany, State of Louisiana, (hereinafter referred to as OWNER),

AND

CITY OF SLIDELL, LOUISIANA, a Louisiana municipality, represented by Salvatore A. "Sam" Caruso, acting in his official capacity as Mayor, and specifically authorized by the Slidell City Council by Ordinance No. 2212 dated October 25, 1988, recorded in the official records of St. Tammany Parish in COB 1363, folio 925, (hereinafter referred to as CITY),

declare that OWNER does hereby grant to CITY a RIGHT-OF-WAY approximately ten (10') feet in width within which to construct, lay, maintain, inspect, operate, repair, alter, remove and relay drainage lines and canals and such drips, valves, fittings, meters, and other equipment and appurtenances as may be necessary or convenient for such operations across and under the following described property situated in the Parish of St. Tammany, State of Louisiana, to-wit:

Lot 155, Lakeshore Village Subdivision, Slidell, St. Tammany Parish, Louisiana, with a municipal address of 3654 Riviera Drive, Slidell, Louisiana 70458.

Together with all rights of ingress and egress to and from the line or lines, or any of them, for the purposes and benefits aforesaid. OWNER shall have the right to fully use and enjoy the above described property, except as to the rights hereinabove granted. CITY hereby agrees and obligates itself to pay any damages which may occur to fences or buildings of the OWNER as a result of the exercise of the rights herein granted.

This servitude is made for and in consideration of the mutual benefits to be derived by the parties.

THUS DONE AND PASSED on the day, month and year herein first above written, in the presence of the undersigned witnesses, who hereunto sign their names with the said appearers and me, Notary, after reading of the whole.

WITNESSES:

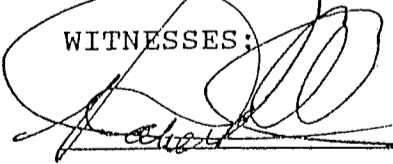

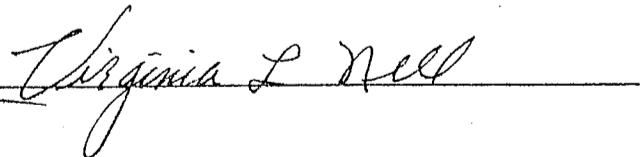
  
Virginia L. Nell

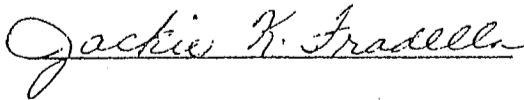
  
Jackie K. Trudell

CITY OF SLIDELL, LOUISIANA

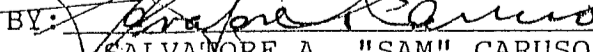
BY:   
SALVATORE A. "SAM" CARUSO  
Mayor

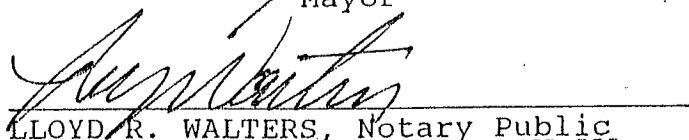
  
LLOYD R. WALTERS, Notary Public

DT. REG # 660:992  
Inst # 998090  
FILED ST. TAMMANY PAR  
05/28/1996 08:30:00AM Pds  
COB\_X MOB\_\_ NI\_\_

GRANT OF DRAINAGE SERVITUDE

STATE OF LOUISIANA

BY: KATHY QUIRK

PARISH OF ST. TAMMANY

TO: CITY OF SLIDELL, LOUISIANA

KNOW ALL MEN BY THESE PRESENTS, that on the 23rd day of April, 1996

KATHY QUIRK, a person of the full age of majority, domiciled in the Parish of St. Tammany, State of Louisiana, (hereinafter referred to as OWNER),

AND

CITY OF SLIDELL, LOUISIANA, a Louisiana municipality, represented by Salvatore A. "Sam" Caruso, acting in his official capacity as Mayor, and specifically authorized by the Slidell City Council by Ordinance No. 2212 dated October 25, 1988, recorded in the official records of St. Tammany Parish in COB 1363, folio 925, (hereinafter referred to as CITY),

declare that OWNER does hereby grant to CITY a RIGHT-OF-WAY approximately ten (10') feet in width within which to construct, lay, maintain, inspect, operate, repair, alter, remove and relay drainage lines and canals and such drips, valves, fittings, meters, and other equipment and appurtenances as may be necessary or convenient for such operations across and under the following described property situated in the Parish of St. Tammany, State of Louisiana, to-wit:

Lot 158, Lakeshore Village Subdivision, Slidell, St. Tammany Parish, Louisiana, with a municipal address of 3624 Riviera Drive, Slidell, Louisiana 70458.

Together with all rights of ingress and egress to and from the line or lines, or any of them, for the purposes and benefits aforesaid. OWNER shall have the right to fully use and enjoy the above described property, except as to the rights hereinabove granted. CITY hereby agrees and obligates itself to pay any damages which may occur to fences or buildings of the OWNER as a result of the exercise of the rights herein granted.

This servitude is made for and in consideration of the mutual benefits to be derived by the parties.

THUS DONE AND PASSED on the day, month and year herein first above written, in the presence of the undersigned witnesses, who hereunto sign their names with the said appearers and me, Notary, after reading of the whole.

WITNESSES:

[Signature]

Kathy Quirk

Jackie K. Fradell

CITY OF SLIDELL, LOUISIANA

BY: [Signature]  
SALVATORE A. "SAM" CARUSO  
Mayor

[Signature]  
LLOYD R. WALTERS, Notary Public

Inst # 998092  
FILED ST. TAMMANY PAR  
05/28/1996 08:30:00AM Pds  
COB\_X MOB MI



GRANT OF DRAINAGE SERVITUDE

STATE OF LOUISIANA

BY: CHARLES L. LANDRY

PARISH OF ST. TAMMANY

TO: CITY OF SLIDELL, LOUISIANA

KNOW ALL MEN BY THESE PRESENTS, that on the 23rd day of April, 199 6

CHARLES L. LANDRY, a persons of the full age of majority, domiciled in the Parish of St. Tammany, State of Louisiana, (hereinafter referred to as OWNER),

AND

CITY OF SLIDELL, LOUISIANA, a Louisiana municipality, represented by Salvatore A. "Sam" Caruso, acting in his official capacity as Mayor, and specifically authorized by the Slidell City Council by Ordinance No. 2212 dated October 25, 1988, recorded in the official records of St. Tammany Parish in COB 1363, folio 925, (hereinafter referred to as CITY),

declare that OWNER does hereby grant to CITY a RIGHT-OF-WAY approximately ten (10') feet in width within which to construct, lay, maintain, inspect, operate, repair, alter, remove and relay drainage lines and canals and such drips, valves, fittings, meters, and other equipment and appurtenances as may be necessary or convenient for such operations across and under the following described property situated in the Parish of St. Tammany, State of Louisiana, to-wit:

Lot 157 Lakeshore Village Subdivision, Slidell, St. Tammany Parish, Louisiana, with a municipal address of 3636 Riviera Drive, Slidell, Louisiana 70458.

Together with all rights of ingress and egress to and from the line or lines, or any of them, for the purposes and benefits aforesaid. OWNER shall have the right to fully use and enjoy the above described property, except as to the rights hereinabove granted. CITY hereby agrees and obligates itself to pay any damages which may occur to fences or buildings of the OWNER as a result of the exercise of the rights herein granted.

This servitude is made for and in consideration of the mutual benefits to be derived by the parties.

THUS DONE AND PASSED on the day, month and year herein first above written, in the presence of the undersigned witnesses, who hereunto sign their names with the said appearers and me, Notary, after reading of the whole.

WITNESSES:

[Signature]

[Signature]

Jackie K. Fradette

CITY OF SLIDELL, LOUISIANA

BY: [Signature]  
SALVATORE A. "SAM" CARUSO  
Mayor

[Signature]  
LLOYD R. WALTERS, Notary Public

IT. REG # 660,988  
Inst # 998086  
FILED ST. TAMMANY PAR  
05/28/1996 08:30:00AM Fds

GRANT OF UTILITY SERVITUDE

STATE OF LOUISIANA

BY: ED GORNAK

PARISH OF ST. TAMMANY

TO: CITY OF SLIDELL, LOUISIANA

DT. REG # 607,962  
Inst # 962243  
FILED ST. TAMMANY PAR  
08/21/1995 08:30:00AM  
COB\_K MOE MI

KNOW ALL MEN BY THESE PRESENTS, that:

ED GORNAK, a person of the full age of majority, residing in Slidell, Louisiana (hereinafter referred to as OWNER),

AND

CITY OF SLIDELL, LOUISIANA, a Louisiana municipality, represented by Salvatore A. "Sam" Caruso, acting in his official capacity as Mayor, and specifically authorized by the Slidell City Council by Ordinance No. 2212 dated October 25, 1988, recorded in the official records of St. Tammany Parish in COB 1363, folio 925, (hereinafter referred to as CITY),

declare that OWNER does hereby grant to CITY a RIGHT-OF-WAY within which to construct, lay, maintain, inspect, operate, repair, alter, remove and relay utility lines and such drips, valves, fittings, meters, and other equipment and appurtenances as may be necessary or convenient for such operations across and under the following described property situated in the Parish of St. Tammany, State of Louisiana, to-wit:

From the South West corner from set iron of Lot 1-B of Square 3 (Log Cabin Subdivision), Section 2, Township 9 South, Range 14 East, which is the Point of Beginning (P.O.B.) proceed North 89 degrees, 04 minutes, 22 seconds West a distance of five (5') feet, which will represent the South East corner of the proposed easement. From the South East corner of the proposed easement proceed North 00 degrees, 25 minutes, 03 seconds West a distance of 278.95 feet to a point which will be the North East corner of the proposed easement. From the North East corner of the proposed easement, proceed South 89 degrees, 05 minutes, 39 seconds West a distance of five (5') feet to the North West corner of the proposed easement which also represents the North West property corner of Lot 1-B of Square 3 (Log Cabin Subdivision), Section 2, Township 9 South, Range 14 East. From this point proceed South 00 degrees, 25 minutes, 03 seconds East a distance of 278.95 feet to the Point of Beginning (P.O.B.).

Together with all rights of ingress and egress to and from the line or lines, or any of them, for the purposes and benefits aforesaid. OWNER shall have the right to fully use and enjoy the above described property, except as to the rights hereinabove granted. CITY hereby agrees and obligates itself to pay any damages which may occur to fences or buildings of the OWNER as a result of the exercise of the Rights herein granted.

This servitude is made for and in consideration of the mutual benefits to be derived by the parties.

\* City hereby agrees & obligates itself to pay any damages which may occur to fences, cement curbs, drive ways, or any other structures on property in construction area,

# MEMORANDUM

FROM LLOYD R. WALTERS, CITY ATTORNEY

TO: Reinhard J. Dearing, Chief of Staff  
Forrest Koder, Planning Department  
Carol Lanoux, Acting Finance Director  
Davis Dautreuil, Council Admin./Clerk of the Council  
Stanley P. Polivick, PE, City Engineer

DATE: August 24, 1995

RE: Grant of Utility Servitude  
Ed Gornak  
(Gause Boulevard Car Wash)

RECEIVED

AUG 24 1995

COUNCIL'S OFFICE

*File 6/20* →

The above-referenced servitude was recorded with the Clerk of Court in Covington on August 21, 1995. Enclosed for your records is a copy of the servitude which reflects it is recorded in COB, Instrument # 962243.

*Met*  
/j kf  
Attachment

N 89° 05' 39" E 5.0'

N 89° 05' 39" E 220.00'

S 89° 04' 22" W 55.00'

REQ'D. 5' EASEMENT

WHITNEY  
NATIONAL  
BANK  
LOT 6

CAR WASH  
LOT 1-B

P.O.B.

GAUSE BLVD.

S 89° 04' 22" W 5.0'

S 00° 25' 03" E 98.87'

S 00° 25' 03" E 180.00'

S 00° 25' 03" E 278.95'

N 00° 25' 03" W 278.95'

S 89° 04' 22" W 165.00'

31/87  
THUS DONE AND PASSED on the 31/87 day of July, 1995, in the presence of the undersigned witnesses, who hereunto sign their names with the said appearer and me, Notary, after reading of the whole.

WITNESSES:

Jackie K. Fradette

Cynthia Martina

Edmond Gornak  
ED GORNAK

CITY OF SLIDELL, LOUISIANA

BY: Salvatore A. Caruso  
SALVATORE A. "SAM" CARUSO  
Mayor

Lloyd E. Walters  
LLOYD E. WALTERS, Notary Public

# MEMORANDUM

FROM LLOYD R. WALTERS, CITY ATTORNEY

RECEIVED

DEC 28 1994

COUNCIL'S OFFICE

TO: Reinhard J. Dearing, Chief of Staff  
Forrest Koder, Planning Department  
Dianne Hanephin, Finance Director  
Davis Dautreuil, Council Admin./Clerk of the Council  
Stanley P. Polivick, PE, City Engineer

DATE: December 27, 1994

RE: Grant of Drainage Servitude  
Elodie P. Gomez  
Bayou Lane Drainage Project  
(Gomez/Coeur De Ville Apartments)

The above-referenced servitude was recorded with the Clerk of Court in Covington on December 13, 1994. Enclosed for your records is a copy of the servitude which reflects it is recorded in COB, Instrument # 931788.

/j kf *jef*  
Attachment

cc: Ms. Elodie P. Gomez-w/enc.

GRANT OF DRAINAGE SERVITUDE

STATE OF LOUISIANA  
PARISH OF ST. TAMMANY

BY: ELODIE P. GOMEZ

TO: CITY OF SLIDELL, LOUISIANA

KNOW ALL MEN BY THESE PRESENTS, that:

ELODIE P. GOMEZ, a person of the full age of majority, residing at 2105 Bayou Lane, Slidell, LA 70458 (hereinafter referred to as OWNER),

AND

CITY OF SLIDELL, LOUISIANA, a Louisiana municipality, represented by Salvatore A. "Sam" Caruso, acting in his official capacity as Mayor, and specifically authorized by the Slidell City Council by Ordinance No. 2212 dated October 25, 1988, recorded in the official records of St. Tammany Parish in COB 1363, folio 925, (hereinafter referred to as CITY),

declare that OWNER does hereby grant to CITY a RIGHT-OF-WAY within which to construct, lay, maintain, inspect, operate, repair, alter, remove and relay drainage lines and canals and such drips, valves, fittings, meters, and other equipment and appurtenances as may be necessary or convenient for such operations across and under the following described property situated in the Parish of St. Tammany, State of Louisiana, to-wit:

All that certain piece of land lying in Lot No. (6) of Section 10, Township 9 South, Range 14 East, Town of Slidell, 9th Ward, St. Tammany Parish, La., being more fully described and delineated as follows to wit:

From the point of beginning also described as the most north easterly property corner proceed: South 26 degrees, 37 minutes West 7.64 feet; thence go North 51 degrees, 30 minutes West 290 feet plus or minus to the ascending bank of Bayou Bonfouca; thence go along Bayou Bonfouca in a northeasterly direction 10 feet plus or minus to an iron set on the northwest property corner of the property bearing municipal address 2021, 2031, 2011, thence go South 51 degrees, 30 minutes East 283.82 feet along the mutual property line to the Point of Beginning. Said easement containing 2175 square feet plus or minus.

Together with all rights of ingress and egress to and from the line or lines, or any of them, for the purposes and benefits aforesaid. OWNER shall have the right to fully use and enjoy the above described property, except as to the rights hereinabove granted. CITY hereby agrees and obligates itself to pay any damages which may occur to fences or buildings of the OWNER as a result of the exercise of the rights herein granted.

This servitude is made for and in consideration of the mutual benefits to be derived by the parties.

THUS DONE AND PASSED on the 1st day of December, 1994, in the presence of the undersigned witnesses, who hereunto sign

DT. REG # 562,970  
Inst # 931788  
FILED ST. TAMMANY PAR  
12/13/1994 08:30:00AM tbt  
COB ~~X~~ MOB \_\_\_ MI \_\_\_

their names with the said appearer and me, Notary, after reading of the whole.

WITNESSES:

Jackie K. Tradella

Elodie P. Gomez  
ELODIE P. GOMEZ

Phyllis P. Merritt

CITY OF SLIDELL, LOUISIANA

BY: Salvatore A. Caruso  
SALVATORE A. "SAM" CARUSO  
Mayor

Lloyd R. Walters  
LLOYD R. WALTERS, Notary Public



GRANT OF DRAINAGE SERVITUDE

STATE OF LOUISIANA  
PARISH OF ST. TAMMANY

BY: ELODIE P. GOMEZ

TO: CITY OF SLIDELL, LOUISIANA

KNOW ALL MEN BY THESE PRESENTS, that:

ELODIE P. GOMEZ, a person of the full age of majority, residing at 2105 Bayou Lane, Slidell, LA 70458 (hereinafter referred to as OWNER),

AND

CITY OF SLIDELL, LOUISIANA, a Louisiana municipality, represented by Salvatore A. "Sam" Caruso, acting in his official capacity as Mayor, and specifically authorized by the Slidell City Council by Ordinance No. 2212 dated October 25, 1988, recorded in the official records of St. Tammany Parish in COB 1363, folio 925, (hereinafter referred to as CITY),

declare that OWNER does hereby grant to CITY a RIGHT-OF-WAY within which to construct, lay, maintain, inspect, operate, repair, alter, remove and relay drainage lines and canals and such drips, valves, fittings, meters, and other equipment and appurtenances as may be necessary or convenient for such operations across and under the following described property situated in the Parish of St. Tammany, State of Louisiana, to-wit:

All that certain piece of land lying in Lot No. (6) of Section 10, Township 9 South, Range 14 East, Town of Slidell, 9th Ward, St. Tammany Parish, La., being more fully described and delineated as follows to wit:

From the point of beginning also described as the most north easterly property corner proceed: South 26 degrees, 37 minutes West 7.64 feet; thence go North 51 degrees, 30 minutes West 290 feet plus or minus to the ascending bank of Bayou Bonfouca; thence go along Bayou Bonfouca in a northeasterly direction 10 feet plus or minus to an iron set on the northwest property corner of the property bearing municipal address 2021, 2031, 2011, thence go South 51 degrees, 30 minutes East 283.82 feet along the mutual property line to the Point of Beginning. Said easement containing 2175 square feet plus or minus.

Together with all rights of ingress and egress to and from the line or lines, or any of them, for the purposes and benefits aforesaid. OWNER shall have the right to fully use and enjoy the above described property, except as to the rights hereinabove granted. CITY hereby agrees and obligates itself to pay any damages which may occur to fences or buildings of the OWNER as a result of the exercise of the rights herein granted.

This servitude is made for and in consideration of the mutual benefits to be derived by the parties.

THUS DONE AND PASSED on the 1st day of December, 1994, in the presence of the undersigned witnesses, who hereunto sign

DT. REG # 562,970  
Inst # 931788  
FILED ST. TAMMANY PAR  
12/13/1994 08:30:00AM tbt  
COB ~~X~~ MOB \_\_\_ MI \_\_\_

their names with the said appearer and me, Notary, after reading of the whole.

WITNESSES:

Jackie K. Tradella  
Phyllis P. Merritt

Elodie P. Gomez  
ELODIE P. GOMEZ

CITY OF SLIDELL, LOUISIANA

BY: Salvatore A. Caruso  
SALVATORE A. "SAM" CARUSO  
Mayor

Lloyd R. Walters  
LLOYD R. WALTERS, Notary Public

# MEMORANDUM

10/16  
Died  
2/1/2

FROM LLOYD R. WALTERS, CITY ATTORNEY

TO: Reinhard J. Dearing, Chief of Staff  
Forrest Koder, Planning Department  
Dianne Hanephin, Finance Director  
Davis Dautreuil, Council Admin./Clerk of the Council  
Stanley P. Polivick, PE, City Engineer

DATE: September 9, 1992

RE: *[Signature]* Grant of Drainage Servitude  
John O. Dye, III, et ux  
to City of Slidell, Louisiana  
(Culvert Line Rehabilitation-Phase D)

RECEIVED

SEP 11 1992

COUNCIL'S OFFICE

The above-referenced servitude was recorded with the Clerk of Court in Covington on September 2, 1992. Enclosed for your records is a copy of the servitude which reflects it is recorded in COB 1520, folio 639.

/jfk *Jackie*  
Attachment

GRANT OF DRAINAGE SERVITUDE

STATE OF LOUISIANA

BY: SUSAN C. MISJA, wife of/and  
JOHN O. DYE, III

PARISH OF ST. TAMMANY

TO: CITY OF SLIDELL, LOUISIANA

KNOW ALL MEN BY THESE PRESENTS, that on the 28th day of  
August, 1992,

SUSAN C. MISJA, wife of/and JOHN O. DYE, III, both  
persons of the full age of majority, domiciled in the  
Parish of St. Tammany, State of Louisiana, (hereinafter  
referred to as OWNER),

AND

CITY OF SLIDELL, LOUISIANA, a Louisiana municipality,  
represented by Salvatore A. "Sam" Caruso, acting in his  
official capacity as Mayor, and specifically authorized  
by the Slidell City Council by Ordinance No. 2212 dated  
October 25, 1988, recorded in the official records of St.  
Tammany Parish in COB 1363, folio 925, (hereinafter  
referred to as CITY),

declare that OWNER does hereby grant to CITY a RIGHT-OF-WAY  
approximately five (5') feet in width within which to construct,  
lay, maintain, inspect, operate, repair, alter, remove and relay  
drainage lines and canals and such drips, valves, fittings, meters,  
and other equipment and appurtenances as may be necessary or  
convenient for such operations across and under the following  
described property situated in the Parish of St. Tammany, State of  
Louisiana, to-wit:

All that certain parcel of land being designated as a 5'  
drainage easement situated on Lot 155, Fountain Estates  
Subdivision, Slidell, St. Tammany Parish, Louisiana,  
being more fully described as follows:

From the southeast corner of said Lot 155, which is the  
point of beginning, proceed North 00 degrees, 06 minutes  
37 seconds West 6.4 feet, thence South 89 degrees, 58  
minutes 40 seconds West 107.0 feet, thence South 00  
degrees 06 minutes 37 seconds East 6.4 feet, thence North  
89 degrees, 58 minutes 40 seconds East 107.0 feet to the  
point of beginning.

Together with all rights of ingress and egress to and from the line  
or lines, or any of them, for the purposes and benefits aforesaid.  
OWNER shall have the right to fully use and enjoy the above  
described property, except as to the rights hereinabove granted.  
CITY hereby agrees and obligates itself to pay any damages which  
may occur to fences or buildings of the OWNER as a result of the  
exercise of the rights herein granted.

CITY also agrees and obligates itself to return the lawn and  
landscaping to its original condition. This may include grating  
and leveling of ground and replacement of equal value of any  
destroyed or damaged trees, shrubs or turf.

OWNER will consider a six foot wooden privacy fence with gate as  
replacement for any damages incurred along property line. OWNER  
has eight (8) twenty (20') foot ligustrum trees along property line  
in back yard. Estimated value from Jack's Nursery is \$225.00 per  
tree or \$1,800.00 total installed price.

This servitude is made for and in consideration of the mutual  
benefits to be derived by the parties.

INSTR. # 829385  
DT. REG # 403613  
FILED ST. TAMMANY PAR  
02SEP9208:30 TBT  
COB 1520 FOLIO 639  
MOB \_\_\_\_\_ FOLIO \_\_\_\_\_

THUS DONE AND PASSED on the day, month and year herein first above written, in the presence of the undersigned witnesses, who hereunto sign their names with the said appearers and me, Notary, after reading of the whole.

WITNESSES:

Jackie F. Traxler  
Robert W. Hatfield

Susan C. Misja Dye  
SUSAN C. MISJA DYE  
John O. Dye, III  
JOHN O. DYE, III

CITY OF SLIDELL, LOUISIANA

BY: Salvatore A. Caruso  
SALVATORE A. "SAM" CARUSO  
Mayor

Lloyd R. Walters  
LLOYD R. WALTERS, Notary Public

# MEMORANDUM

FROM LLOYD R. WALTERS, CITY ATTORNEY

TO: Reinhard J. Dearing, Chief of Staff  
Forrest Koder, Planning Department  
Dianne Hanephin, Finance Director  
Davis Dautreuil, Council Admin./Clerk of the Council  
Stanley P. Polivick, PE, City Engineer

DATE: September 29, 1992

RE: Grant of Servitudes  
Slidell Motor Hotel, Inc.  
(Holiday Square/Cracker Barrel)

*file  
w/annexation  
ordinance 2/12*

Five servitudes donated to the City by Slidell Motor Hotel, Inc. over the Holiday Square/Cracker Barrel property were recorded with the Clerk of Court in Covington on September 17, 1992. Attached for your records are copies of the servitudes which reflect the recording information.

*K*/j kf  
Attachments

RECEIVED

SEP 30 1992

COUNCIL'S OFFICE

GRANT OF SERVITUDE

STATE OF LOUISIANA

BY: SLIDELL MOTOR HOTEL, INC.

PARISH OF ST. TAMMANY

TO: CITY OF SLIDELL, LOUISIANA

KNOW ALL MEN BY THESE PRESENTS, that on the 5<sup>th</sup> day of September, 1992,

SLIDELL MOTOR HOTEL, INC., a domestic corporation organized under the laws of the State of Louisiana, domiciled in the Parish of St Tammany, represented herein by JAMES E. HULSEY, Vice President-Operations,

(hereinafter referred to as OWNER),

AND

CITY OF SLIDELL, LOUISIANA, a Louisiana municipality, represented by Salvatore A. "Sam" Caruso, acting in his official capacity as Mayor, and specifically authorized by the Slidell City Council by Ordinance No. 2212 dated October 25, 1988, recorded in the official records of St. Tammany Parish in COB 1363, folio 925,

(hereinafter referred to as CITY),

INSTR. # 831005  
DT. REG # 406105  
FILED ST. TAMMANY PAR  
17SEP9208:30 TMB  
COB 1363 FOLIO 584  
Municipality, FOLIO \_\_\_\_\_

declare that OWNER does hereby grant to CITY a RIGHT-OF-WAY approximately thirty (30') feet in width within which to construct, lay, maintain, inspect, operate, repair, alter, remove and relay lift station and utility lines and such drips, valves, fittings, meters, and other equipment and appurtenances as may be necessary or convenient for such operations across and under the following described property situated in the Parish of St. Tammany, State of Louisiana, to-wit:

Utility servitude (from Lot 2, Holiday Square, Cracker Barrel East property line to reserved Natchez Dr. right-of-way including lift station area)

All that certain parcel of land situated in Section 12, Township 9 South, Range 14 East, St. Tammany Parish, La. more fully described as follows:

From the 1/4 corner common to Sections 12 and 13 of said Township and Range go North 00 degrees, 15 minutes, 00 seconds East 2,650.00 feet to a point; thence go South 89 degrees, 55 minutes, 00 seconds West 618.49 feet to a point; Thence go North 1 degree, 06 minutes, 42 seconds East 1,382.52 feet to the Point of Beginning;

Thence go North 00 degrees, 15 minutes, 46 seconds West 30 feet to a point;

Thence go North 89 degrees, 55 minutes, 00 seconds West 167.4 feet to a point;

Thence go due South 00 degrees, 00 minutes, 00 seconds 30 feet to a point;

Thence go South 89 degrees, 55 minutes, 00 seconds East 50 feet to a point;

Thence go South 00 degrees, 15 minutes, 46 seconds East 45 feet to a point;

Thence go North 89 degrees, 55 minutes, 00 seconds East 25 feet to a point;

Thence go North 00 degrees, 15 minutes, 46 seconds West  
45 feet to a point;

Thence go North 89 degrees, 55 minutes, 00 seconds East  
92.54 feet to the Point of Beginning.

The exact location and dimensions of the servitude are more fully delineated on the sketch of City of Slidell Engineering Department dated July, 1992, attached hereto as Exhibit A.

Together with all rights of ingress and egress to and from the property for the purposes and benefits aforesaid. OWNER shall have the right to fully use and enjoy the above described property, except as to the rights hereinabove granted. CITY hereby agrees and obligates itself to pay any damages which may occur to fences or buildings of the OWNER as a result of the exercise of the rights herein granted.

This servitude is made for and in consideration of the mutual benefits to be derived by the parties.

THUS DONE AND PASSED on the day, month and year herein first above written, in the presence of the undersigned witnesses, who hereunto sign their names with the said appearers and me, Notary, after reading of the whole.

WITNESSES:

SLIDELL MOTOR HOTEL, INC.

Sue Hulsey  
[Signature]

BY: [Signature]  
JAMES E. HULSEY  
Vice President-Operations

CITY OF SLIDELL, LOUISIANA

BY: [Signature]  
SALVATORE A. "SAM" CARUSO  
Mayor

[Signature]  
LLOYD R. WALTERS, Notary Public



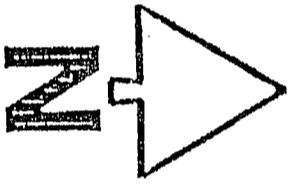

SCALE: 1" = 30'

HOLIDAY INN

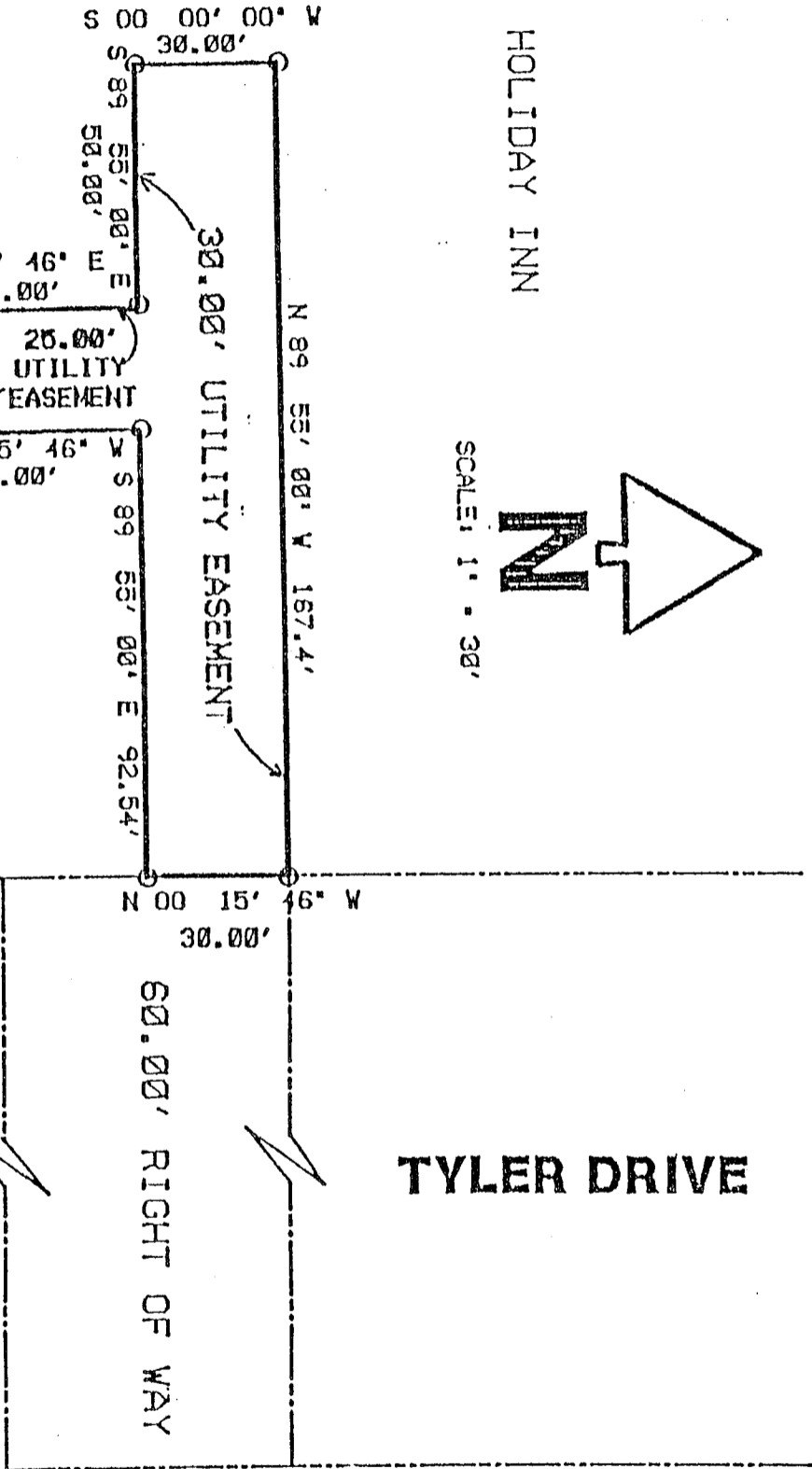

CRACKER BARREL

EXIST. PUMP STATION

City of Sisdell Engineering Department

SCALE: As Noted

APPROVED BY: SPP

DRAWN BY BSR

DATE: July, 1992

REVISED

UTILITY EASEMENT  
FOR HOLIDAY INN/CRACKER BARREL

DRAWING NUMBER

# MEMORANDUM

FROM LLOYD R. WALTERS, CITY ATTORNEY

TO: Reinhard J. Dearing, Chief of Staff  
Forrest Koder, Planning Department  
Dianne Hanephin, Finance Director  
Davis Dautreuil, Council Admin./Clerk of the Council  
Stanley P. Polivick, PE, City Engineer

DATE: September 25, 1992

*not 2212*  
*file* →  
RE: Grant of Utility Servitude  
Aldersgate United Methodist Church  
(Sewer Expansion)

The above-referenced servitude was recorded with the Clerk of Court in Covington on September 16, 1992. Enclosed for your records is a copy of the servitude which reflects it is recorded in COB 1522, folio 405.

*W*  
/jkr  
Attachment

GRANT OF UTILITY SERVITUDE

STATE OF LOUISIANA

BY: ALDERSGATE UNITED METHODIST CHURCH

PARISH OF ST. TAMMANY

TO: CITY OF SLIDELL, LOUISIANA

KNOW ALL MEN BY THESE PRESENTS, that on the 11<sup>th</sup> day of SEPTEMBER, 1992,

ALDERSGATE UNITED METHODIST CHURCH, represented herein by Hugh Riley and Ned Williams, Co-Chair of the Board of Trustees, (hereinafter referred to as Owner),

AND

CITY OF SLIDELL, LOUISIANA, a Louisiana municipality, represented by Salvatore A. "Sam" Caruso, acting in his official capacity as Mayor, and specifically authorized by the Slidell City Council by Ordinance No. 2212 dated October 25, 1988, recorded in the official records of St. Tammany Parish in COB 1363, folio 925, (hereinafter referred to as CITY),

declare that OWNER does hereby grant to CITY a RIGHT-OF-WAY approximately five (5') feet in width within which to construct, lay, maintain, inspect, operate, repair, alter, remove and relay utility lines and such drips, valves, fittings, meters, and other equipment and appurtenances as may be necessary or convenient for such operations across and under the following described property situated in the Parish of St. Tammany, State of Louisiana, to-wit:

All that certain portion of land situated in Section 36, Township 8 South, Range 14 East, St. Tammany Parish, Louisiana, more fully described as follows:

From the section corner common to Sections 36, 35 of Township 8 S and Sections 1, 2 of Township 9 S then proceed 711.8 feet due east to the point of beginning.

Thence proceed N 08 degrees, 05 minutes, 55 seconds West 881.45 feet along the eastern most property line of Aldersgate Church to a point;

Thence South 37 degrees, 08 minutes, 30 seconds West 6.23 feet along the north most property line of Aldersgate Church to a point;

Thence South 08 degrees, 05 minutes, 55 seconds East 873.96 feet to a point on the southernmost property line;

Thence due East 5.05 feet to the point of beginning.

Together with all rights of ingress and egress to and from the line or lines, or any of them, for the purposes and benefits aforesaid. OWNER shall have the right to fully use and enjoy the above described property, except as to the rights hereinabove granted. CITY hereby agrees and obligates itself to pay any damages which may occur to fences or buildings of the OWNER as a result of the exercise of the rights herein granted.

This servitude is made for and in consideration of the mutual benefits to be derived by the parties.

THUS DONE AND PASSED on the day, month and year herein first above written, in the presence of the undersigned witnesses, who hereunto

INSTR. # 830862  
DT. REG # 405830  
FILED ST. TAMMANY PAR  
16 SEP 92 08:30 TMB  
COB 1363 FOLIO 925  
MOB \_\_\_\_\_ FOLIO \_\_\_\_\_

sign their names with the said appearers and me, Notary, after reading of the whole.

WITNESSES:

ALDRERSGATE UNITED METHODIST CHURCH

Jackie K. Trudell

BY:

HUGH RILEY  
Co-Chair, Board of Trustees

Stephen M. Hill

BY:

NEB WILLIAMS  
Co-Chair, Board of Trustees

CITY OF SLIDELL, LOUISIANA

BY:

SALVATORE A. "SAM" CARUSO  
Mayor

Lloyd R. Walters

LLOYD R. WALTERS, Notary Public

file  
old 22/2



RECEIVED

MAY 29 1991

# The City of Slidell

COUNCIL'S OFFICE

SALVATORE A. "SAM" CARUSO, Mayor

2055 Second Street • P. O. Box 828 • Slidell, Louisiana 70459

Telephone (504) 646-4330

TO: Reinhard J. Dearing, Chief of Staff  
Forrest Koder, Planning Department  
Dianne Hanephin, Finance Director  
Davis Dautreuil, Council Administrator/Clerk of the Council  
Stanley P. Polivick, PE, City Engineer

FROM: Jackie Fradella, Secretary to Lloyd R. Walters *JKF*

DATE: May 29, 1991

SUBJECT: Grant of Servitude  
Aldersgate United Methodist Church



Attached for your records is a copy of the above-referenced servitude which has been recorded with the Clerk of Court in Covington in COB 1458, folio 370.

/j kf  
Attachment

GRANT OF SERVITUDE

STATE OF LOUISIANA

BY: ALDERSGATE UNITED METHODIST CHURCH

PARISH OF ST. TAMMANY

TO: CITY OF SLIDELL, LOUISIANA

KNOW ALL MEN BY THESE PRESENTS, THAT ON April 10, 1991,

ALDERSGATE UNITED METHODIST CHURCH, represented herein by John Watson and Roger Rivet, Co-Chair of the Board of Trustees, (hereinafter referred to as OWNER),

and

CITY OF SLIDELL, LOUISIANA (hereinafter referred to as CITY), a Louisiana municipality, represented by Salvatore A. "Sam" Caruso, acting in his official capacity as Mayor, and specifically authorized by the Slidell City Council by Ordinance No. 2212 dated October 25, 1988, recorded in the official records of St. Tammany Parish in COB 1363, folio 925.

declare that OWNER does hereby grant to CITY, a servitude approximately six (6') feet x three (3') feet as shown on the attached sketch marked as "Exhibit A" within which to construct, lay, maintain, inspect, operate, repair, alter, remove and relay a fire hydrant on the following described property situated in the Parish of St. Tammany, State of Louisiana, to-wit:

A certain parcel of land situated in Section 36, Township 8 South, Range 14 East, St. Tammany Parish, Louisiana, being more fully described as follows:  
From the Southwest corner of said Section 36, go East 469.1 feet to an iron and the point of beginning.  
Thence North 496.97 feet to an iron;  
Thence North 23 degrees, 57 minutes, 10 seconds West 154.75 feet to an iron set in the Southerly edge of Robert Road;  
Thence Northeasterly along said Southerly edge in three courses:

North 37 degrees, 23 minutes, 50 seconds  
East 50.0 feet to an iron; North 38 degrees, 45 minutes, 30 Seconds East 100.0 feet to an iron, and North 37 degrees, 08 minutes, 30 seconds East 146.2 feet to an iron;

Thence South 8 degrees, 05 minutes, 55 seconds East 881.45 feet to an iron;  
Thence West 242.7 feet to the point of beginning.  
Containing in all 3.56 acres of land, more or less.

Together with all rights of ingress and egress to and from the line or lines, or any of them, for the purposes and benefits aforesaid. OWNER shall have the right to fully use and enjoy the above described property, except as to the rights hereinabove granted. CITY hereby agrees and obligates itself to pay any damages which may occur to fences or buildings of the OWNER as a result of the exercise of the rights herein granted.

This servitude is made for and in consideration of the mutual benefits to be derived by the parties.

INSTR. # 779434  
DT. REG # 325695  
FILED ST. TAMMANY PAR  
18 APR 1991 5:50 TBT  
COB 1458 FOLIO 370  
MOB \_\_\_\_\_ FOLIO \_\_\_\_\_

In witness whereof, the undersigned have set their names in the presence of the undersigned competent witnesses, who hereunto sign their names with the said appearers.

WITNESSES:

ALDRSGATE UNITED METHODIST CHURCH

[Handwritten Signature]

BY:

[Handwritten Signature: John Watson]

JOHN WATSON  
Co-Chair, Board of Trustees

[Handwritten Signature]

BY:

[Handwritten Signature: Roger Rivet]

ROGER RIVET  
Co-Chair, Board of Trustees

SWORN TO AND SUBSCRIBED before me this 3 day of

~~April~~ April, 1991.

[Handwritten Signature: Alan Blank]

NOTARY PUBLIC

STATE OF LOUISIANA

PARISH OF ST. TAMMANY

WITNESSES:

CITY OF SLIDELL

[Handwritten Signature]

[Handwritten Signature: Depue D. Gulino]

[Handwritten Signature: Salvatore A. Caruso]

BY:

SALVATORE A. "SAM" CARUSO  
Mayor

SWORN TO AND SUBSCRIBED before me this 10th day of

April, 1991.

[Handwritten Signature: Lloyd R. Walters]

LLOYD R. WALTERS, Notary Public

ROBERT BLVD.

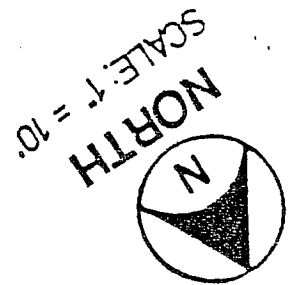
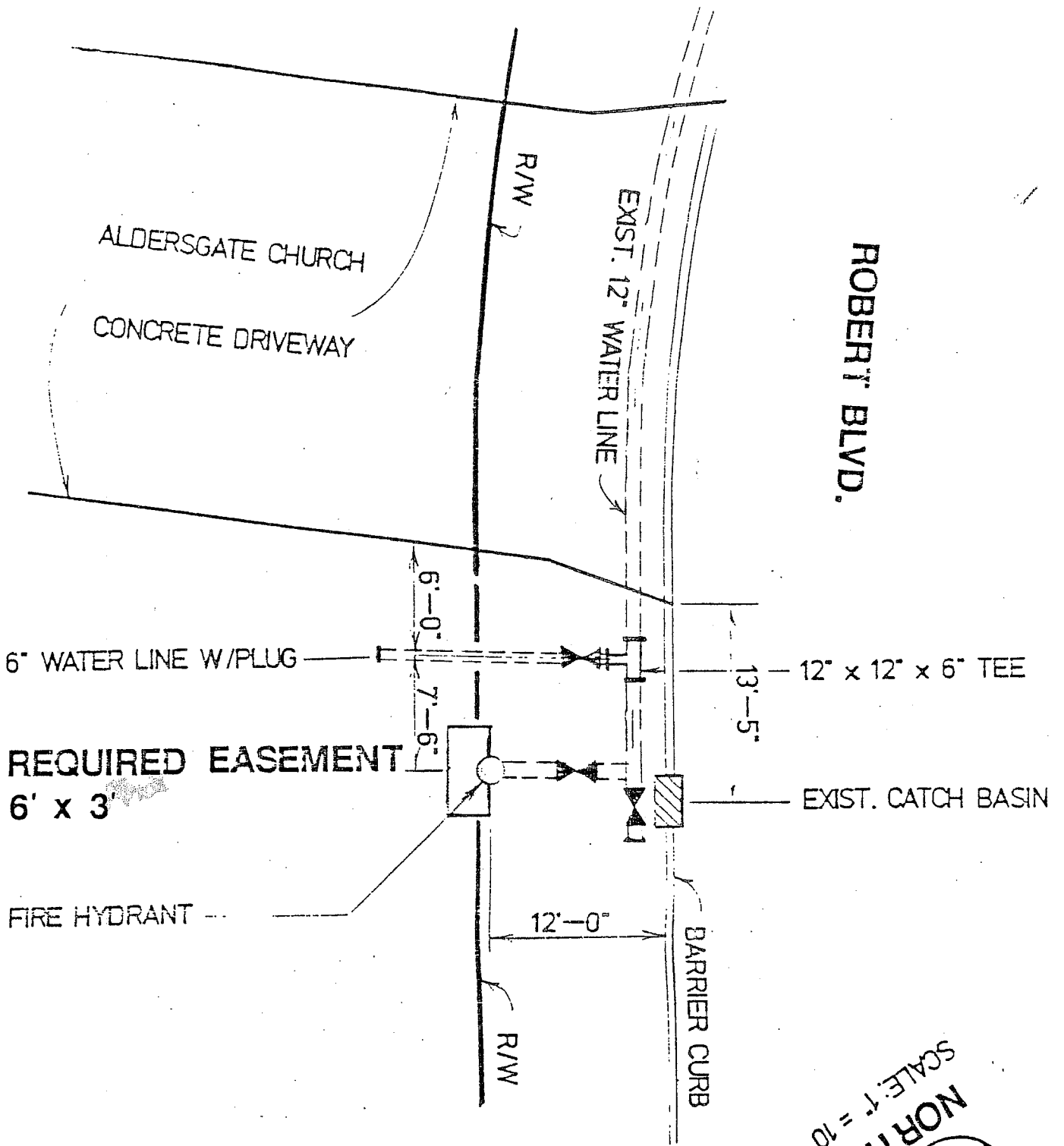

"Exhibit A"





RECEIVED

MAY 29 1991

COUNCIL'S OFFICE

# The City of Slidell

SALVATORE A. "SAM" CARUSO, Mayor  
2055 Second Street • P. O. Box 828 • Slidell, Louisiana 70459  
Telephone (504) 646-4330

TO: Reinhard J. Dearing, Chief of Staff  
Forrest Koder, Planning Department  
Dianne Hanephin, Finance Director  
Davis Dautreuil, Council Administrator/Clerk of the Council  
Stanley P. Polivick, PE, City Engineer

FROM: Jackie Fradella, Secretary to Lloyd R. Walters *JKF*

DATE: May 29, 1991

SUBJECT: Grant of Servitude  
Blackjack Investment Corporation and  
Ronald N. Lybrand  
(Lakewood Pump Station No. 301 Project)  
LRL Associates, Ltd.  
(Lakewood Pump Station No. 301 Project)  
File No. 90-C-0126

Attached for your records are copies of the above-referenced servitudes which have been recorded with the Clerk of Court in Covington as follows:

Blackjack/Lybrand--COB 1459, folio 649  
LRL --COB 1459, folio 651

/j kf  
Attachments

GRANT OF SERVITUDE

STATE OF TEXAS  
COUNTY OF TRAVIS

BY: BLACKJACK INVESTMENT CORPORATION  
and RONALD N. LYBRAND

STATE OF LOUISIANA  
PARISH OF JEFFERSON

TO: CITY OF SLIDELL

STATE OF LOUISIANA  
PARISH OF ST. TAMMANY

KNOW ALL MEN BY THESE PRESENTS, THAT ON March 20th, 1991,

BLACKJACK INVESTMENT CORPORATION, represented herein by WILLIAM C. DAVIS, its president; and RONALD N. LYBRAND, a person of the full age of majority, residing in the Parish of Jefferson, State of Louisiana (hereinafter referred to as OWNER),

and

CITY OF SLIDELL, LOUISIANA (hereinafter referred to as CITY);

declare that OWNER does hereby grant to CITY, a servitude approximately ten (10') feet in width within which to construct, lay, maintain, inspect, operate, repair, alter, remove and relay utility lines for transportation of sewerage and such drips, valves, fittings, meters, and other equipment and appurtenances as may be necessary or convenient for such operations across and under the following described property situated in the Parish of St. Tammany, State of Louisiana, to-wit:

The easement measures three hundred three and six-tenths (303.6') feet along the South right-of-way of Gause Boulevard, by a depth of ten (10') feet along its easterly sideline, the west right-of-way of Lindberg Drive, by a depth of ten (10') feet along its westerly sideline, by a measure of three hundred three and six-tenths (303.6') feet across the rear on that certain parcel of land situated in Section 11, Township 9 South, Range 14 East, Greensburg District, St. Tammany Parish, Louisiana, being more fully described as follows:

PARCEL 1

Commence at the Northeast corner of Section 11, T9S, R14E; thence south 69.49 feet to the point of beginning; thence South, 200.00 feet; thence West, 214.00 feet; thence North 0 degrees, 39 minutes 30 seconds West 200.47 feet actual (200.41 feet as per title) to a point on the South right of way of Gause Road; thence North 88 degrees 59 minutes 51 seconds East, along said right of way, 28.03 feet; thence North 89 degrees 20 minutes 10 seconds East, along said right of way, 185.57 feet to the point of beginning.

PARCEL 2

Commence at the Northeast corner of Section 11, T9S, R14E; thence South 69.49 feet to the point of beginning; thence South, 200.00 feet; thence East, 90 feet, more or less, to a point on the West right of way line of Lindbergh Drive; then Northwardly along said West right of way line of Lindbergh Drive 199.67 feet actual (200.00 feet as per title), to a point on the South right of way line of Gause Road, thence Westwardly along said Gause Road right of way a distance of 90 feet, more or less, to the point of beginning.

INSTR. # 780696  
DT. REG # 327691  
FILED ST. TAMMANY PAR  
91MAY9115:15 TTF  
COE 1459 FOLIO 1649  
NOE \_\_\_\_\_ FOLIO \_\_\_\_\_

Together with all rights of ingress and egress to and from the line or lines, or any of them, for the purposes and benefits aforesaid. OWNER shall have the right to fully use them and enjoy the above described property, except as to the rights hereinabove granted.

CITY agrees to replace any improvements on the property that must be removed to lay the utility lines.

This servitude is made for and in consideration of the mutual benefits to be derived by the parties.

In witness whereof, the undersigned have set their names in the presence of the undersigned competent witnesses, who hereunto sign their names with the said appearers.

STATE OF TEXAS  
COUNTY OF TRAVIS

WITNESSES:

BLACKJACK INVESTMENT CORPORATION

Richard L Childers

BY: William C. Davis  
WILLIAM C. DAVIS, President

Lisa Herrmann

SWORN TO AND SUBSCRIBED before me this 20<sup>th</sup> day of

March, 1991.

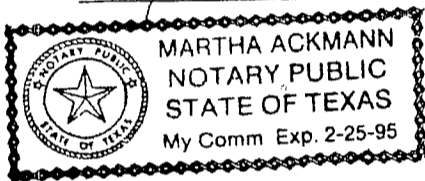

Martha Ackmann  
NOTARY PUBLIC

STATE OF LOUISIANA  
PARISH OF JEFFERSON

WITNESSES:

Melissa Adams Burt

Ronald N. Lybrand  
RONALD N. LYBRAND

May M Sullivan

SWORN TO AND SUBSCRIBED before me this 25<sup>th</sup> day of

March, 1991.

Richard J. Rosen  
NOTARY PUBLIC

STATE OF LOUISIANA  
PARISH OF ST. TAMMANY

WITNESSES:

CITY OF SLIDELL

Jackie K. Tracell

Judy Zerai

BY: Salvatore A. Caruso  
SALVATORE A. "SAM" CARUSO  
Mayor

SWORN TO AND SUBSCRIBED before me this 26th day of

April, 1991.

Lloyd R. Walters  
LLOYD R. WALTERS, Notary Public

GRANT OF SERVITUDE

BY: LRL ASSOCIATES, LTD.

STATE OF LOUISIANA

TO: CITY OF SLIDELL

PARISH OF ST. TAMMANY

KNOW ALL MEN BY THESE PRESENTS, THAT ON April 26, 1991,

LRL ASSOCIATES, LTD., represented herein by LEONARD LEVIN, General Partner (hereinafter referred to as OWNER),

and

CITY OF SLIDELL, LOUISIANA (hereinafter referred to as CITY), a Louisiana municipality, represented by Salvatore A. "Sam" Caruso, acting in his official capacity as Mayor, and specifically authorized by the Slidell City Council by Ordinance No. 2212 dated October 25, 1988, recorded in the official records of St. Tammany Parish in COB 1363, folio 925;

declare that OWNER does hereby grant to CITY, a servitude approximately ten (10') feet in width within which to construct, lay, maintain, inspect, operate, repair, alter, remove and relay utility lines for transportation of sewerage and such drips, valves, fittings, meters, and other equipment and appurtenances as may be necessary or convenient for such operations across and under the following described property situated in the Parish of St. Tammany, State of Louisiana, to-wit:

The easement measures four hundred eleven and four-tenths (411.4') feet along the South right-of-way of Gause Road; by a depth of ten (10') feet on its easterly sideline, by a depth of ten (10') feet on its westerly sideline by a measure of four hundred eleven and four-tenths (411.4') feet across the rear. on that certain parcel of land being designated as a 10' easement situated in Section 11, Township 9 South, Range 14 East, Greensburg District, St. Tammany Parish, Louisiana, being more fully described as follows:

Commence at the Northeast corner of Section 11, T9S, R14E; thence south 69.49 feet to a point on the South right-of-way of Gause Road; thence N 89 degrees, 50'40" W, 185.57' along said right-of-way; thence S 89 degrees, 49'01" W, 28.03' along said right-of-way to the point of beginning; thence S 00 degrees, 06'41" W, 200.41 feet; thence East 214'; thence South, 850.00'; thence N 89 degrees, 52' W, 625.00'; thence North, 1047.65' to a point on the South right-of-way of Gause Road; thence N 89 degrees, 49'01" E, along said right-of-way 411.4' to the point of beginning.

Together with all rights of ingress and egress to and from the line or lines, or any of them, for the purposes and benefits aforesaid. OWNER shall have the right to fully use them and enjoy the above described property, except as to the rights hereinabove granted.

CITY agrees to replace any improvements on the property that must be removed to lay the utility lines.

This servitude is made for and in consideration of the price and sum of TWO THOUSAND FOUR HUNDRED SIXTY-EIGHT AND 00/100 (\$2,468.00) DOLLARS, ~~cash in hand paid~~ <sup>which will be paid with 2 weeks of receipt</sup> the receipt of which is hereby acknowledged and full acquittance and discharge therefor given and future advantages and benefits.

INSTR. # 780698  
DT. REG # 327694  
FILED ST. TAMMANY PAR  
91MAY31 15:15 TTF  
COB 1459 FOLIO 1651

In witness whereof, the undersigned have set their names in the presence of the undersigned competent witnesses, who hereunto sign their names with the said appearers.

WITNESSES:

[Signature]  
Jackie F. Franklin

LRL ASSOCIATES, LTD

BY: [Signature]  
LEONARD LEVIN, General Partner

SWORN TO AND SUBSCRIBED before me this 22nd day of April, 1991.

[Signature]  
NOTARY PUBLIC

[Signature]  
Judy Zerai

CITY OF SLIDELL

BY: [Signature]  
SALVATORE A. "SAM" CARUSO  
Mayor

SWORN TO AND SUBSCRIBED before me this 26th day of April, 1991.

[Signature]  
LLOYD R. WALTERS, Notary Public



ORD 2212

# The City of Slidell

SALVATORE A. "SAM" CARUSO, Mayor  
2055 Second Street • P. O. Box 828 • Slidell, Louisiana 70459  
Telephone (504) 646-4330

TO: Reinhard J. Dearing, Chief of Staff  
Forrest Koder, Planning Department  
Dianne Hanephin, Finance Director  
Davis Dautreuil, Council Administrator/Clerk of the Council  
Stanley P. Polivick, PE, City Engineer

FROM: Jackie Fradella, Secretary to Lloyd R. Walters *JFK*

DATE: March 14, 1991

SUBJECT: Grant of Servitude  
Frank B. Franze  
(Culvert Line Rehabilitation-Phase C)  
File No. 90-C-0156

Attached for your records is a copy of the above-referenced servitude which has been recorded with the clerk of Court in Covington in COB 1453, folio 216.

/j kf  
Attachment

GRANT OF DRAINAGE SERVITUDE

STATE OF LOUISIANA

BY: FRANK B. FRANZE

PARISH OF ST. TAMMANY

TO: CITY OF SLIDELL, LOUISIANA

KNOW ALL MEN BY THESE PRESENTS, THAT ON February 27, 1991,

FRANK B. FRANZE, a person of the full age of majority, domiciled in the Parish of St. Tammany, State of Louisiana, (hereinafter referred to as OWNER),

and

CITY OF SLIDELL, LOUISIANA (hereinafter referred to as CITY), a Louisiana municipality, represented by Salvatore A. "Sam" Caruso, acting in his official capacity as Mayor, and specifically authorized by the Slidell City Council by Ordinance No. 2212 dated October 25, 1988, recorded in the official records of St. Tammany Parish in COB 1363, folio 925.

declare that OWNER does hereby grant to CITY, a RIGHT-OF-WAY approximately five (5) feet within which to construct, lay, maintain, inspect, operate, repair, alter, remove and relay drainage lines and canals and such drips, valves, fittings, meters, and other equipment and appurtenances as may be necessary or convenient for such operations across and under the following described property situated in the Parish of St. Tammany, State of Louisiana, to-wit:

All that certain parcel of land being designated as a 5' drainage easement situated on Lot 79, Forest Glen East Subdivision, Unit No. 2, Slidell, St. Tammany Parish, Louisiana, being more fully described as follows:

From the southeast corner of said Lot 79, which is the point of beginning, proceed N89°58'W 5.0 feet, thence N00°02'E 112.5 feet, then S89°58'E 5.0 feet, thence S00°02'W 112.5 feet to the point of beginning.

Together with all rights of ingress and egress to and from the line or lines, or any of them, for the purposes and benefits aforesaid. OWNER shall have the right to fully use them and enjoy the above described property, except as to the rights hereinabove granted. CITY hereby agrees and obligates itself to pay any damages which may occur to fences or buildings of the OWNER as a result of the exercise of the rights herein granted.

This servitude is made for and in consideration of the mutual benefits to be derived by the parties.

In witness whereof, the undersigned have set their names in the presence of the undersigned competent witnesses, who hereunto sign their names with the said appearers.

WITNESSES:

Terri G. Dupuis

Frank B. Franze  
FRANK B. FRANZE

Vick Conner

INSTR. # 774974  
DT. REG # 318693  
FILED ST. TAMMANY PAR  
28 FEB 1991 11:50 AM  
COB 1363 FOLIO 925  
MOB \_\_\_\_\_ FOLIO \_\_\_\_\_

WITNESSES:

CITY OF SLIDELL

Jackie K. Franze  
[Signature]

BY: [Signature]  
SALVATORE A. "SAM" CARUSO  
MAYOR

STATE OF LOUISIANA

PARISH OF ST. TAMMANY

BEFORE ME, on February 13, 1991, the undersigned authority, personally came and appeared Frank B. Franze and Linda C. Franze who, being duly sworn, did depose and say that he signed this instrument as a witness, in the presence of OWNER and another subscribing witness, all of whom signed in his presence, each signing in the presence of all the other, and that all of the signatures are genuine.

WITNESSES:

[Signature]  
[Signature]

[Signature]  
[Signature]  
[Signature]  
Notary Public

STATE OF LOUISIANA

PARISH OF ST. TAMMANY:

BEFORE ME, on February 27, 1991, the undersigned authority, personally came and appeared Jackie K. Franze who, being duly sworn, did depose and say that she signed this instrument as a witness, in the presence of the CITY and another subscribing witness, all of whom signed in her presence, each signing in the presence of all the other, and that all of the signatures are genuine.

WITNESSES:

[Signature]  
[Signature]

Jackie K. Franze  
[Signature]  
LLOYD R. WALTERS, Notary Public



WITNESSES:

CITY OF SLIDELL

Jackie K. Franze  
4

BY: Salvatore A. Caruso  
SALVATORE A. "SAM" CARUSO  
MAYOR

STATE OF LOUISIANA

PARISH OF ST. TAMMANY

BEFORE ME, on February 13, 1991, the undersigned authority, personally came and appeared Frank B. Franze and Linda C. Franze who, being duly sworn, did depose and say that he signed this instrument as a witness, in the presence of OWNER and another subscribing witness, all of whom signed in his presence, each signing in the presence of all the other, and that all of the signatures are genuine.

WITNESSES:

Muri L. Dupuis  
Cindy K. [unclear]

Frank B. Franze  
Linda C. Franze  
Nancy E. [unclear]  
Notary Public

STATE OF LOUISIANA

PARISH OF ST. TAMMANY:

BEFORE ME, on February 27, 1991, the undersigned authority, personally came and appeared Jackie K. Franze, who, being duly sworn, did depose and say that she signed this instrument as a witness, in the presence of the CITY and another subscribing witness, all of whom signed in her presence, each signing in the presence of all the other, and that all of the signatures are genuine.

WITNESSES:

[unclear]  
Michelle Durant

Jackie K. Franze  
[unclear]  
LLOYD R. WALTERS, Notary Public



# *The City of Slidell*

SALVATORE A. "SAM" CARUSO, Mayor  
2055 Second Street • P. O. Box 828 • Slidell, Louisiana 70459  
Telephone (504) 646-4300

TO: Reinhard J. Dearing  
Forrest Koder  
Dianne Hanephin ✓  
Davis Dautreuil ✓  
Stan Polivick

FROM: Jackie Fradella, Secretary to Elaine W. Guillot *JF*

DATE: June 7, 1990

SUBJECT: Grants of Servitude  
David Varacalle  
Louis P. Lagarde, Jr., et ux  
(Culvert Line Rehabilitation-Phase C)

Attached for your records are copies of the above-referenced servitudes which have been recorded with the Clerk of Court in Covington.

/j kf  
Attachments

GRANT OF DRAINAGE SERVITUDE

STATE OF LOUISIANA

BY: DAVID VARACALLE

PARISH OF ST. TAMMANY

TO: CITY OF SLIDELL, LOUISIANA

KNOW ALL MEN BY THESE PRESENTS, THAT ON May 16, 1990,

DAVID VARACALLE, a person of the full age of majority, domiciled in the Parish of St. Tammany, State of Louisiana, (hereinafter referred to as OWNER),

and

CITY OF SLIDELL, LOUISIANA (hereinafter referred to as CITY), a Louisiana municipality, represented by Salvatore A. "Sam" Caruso, acting in his official capacity as Mayor, and specifically authorized by the Slidell City Council by Ordinance No. 2212 dated October 25, 1988, recorded in the official records of St. Tammany Parish in COB 1363, folio 925.

declare that OWNER does hereby grant to CITY, a RIGHT-OF-WAY approximately five (5) feet within which to construct, lay, maintain, inspect, operate, repair, alter, remove and relay drainage lines and canals and such drips, valves, fittings, meters, and other equipment and appurtenances as may be necessary or convenient for such operations across and under the following described property situated in the Parish of St. Tammany, State of Louisiana, to-wit:

All that certain parcel of land being designated as a 5' drainage easement situated on Lot 156, Fountain Estates Subdivision, Slidell, St. Tammany Parish, Louisiana, being more fully described as follows:

From the northeast corner of said Lot 156, which is the point of beginning, proceed S00°06'37"E 3.6 feet, thence S89°58'40"W 107.0 feet, thence N00°06'37"E 3.6 feet, thence N89°58'40"W 107.0 feet to the point of beginning.

Together with all rights of ingress and egress to and from the line or lines, or any of them, for the purposes and benefits aforesaid. OWNER shall have the right to fully use them and enjoy the above described property, except as to the rights hereinabove granted. CITY hereby agrees and obligates itself to pay any damages which may occur to fences or buildings of the OWNER as a result of the exercise of the rights herein granted.

This servitude is made for and in consideration of the mutual benefits to be derived by the parties.

In witness whereof, the undersigned have set their names in the presence of the undersigned competent witnesses, who hereunto sign their names with the said appearers.

WITNESSES:

Josie P. Francis

David Varacalle  
DAVID VARACALLE

Diana D. Hall

INSTR. # 751204  
ST. REG # 290342  
FILED ST. TAMMANY PAR  
31MAY9009:00 TJF  
JSE [Signature]  
COB \_\_\_\_\_

WITNESSES:

CITY OF SLIDELL

Jackie K. Fradella

BY: Salvatore A. "Sam" Caruso  
SALVATORE A. "SAM" CARUSO  
MAYOR

Dianna D. Kroe

STATE OF LOUISIANA

PARISH OF ST. TAMMANY

BEFORE ME, on May 8, 1990, the undersigned authority, personally came and appeared Jackie K. Fradella, who, being duly sworn, did depose and say that he signed this instrument as a witness, in the presence of OWNER and another subscribing witness, all of whom signed in his presence, each signing in the presence of all the other, and that all of the signatures are genuine.

WITNESSES:

Dianna D. Kroe

Jackie K. Fradella  
JACKIE K. FRADELLA

Charlene Broussard

Elaine W. Guillot  
Notary Public

STATE OF LOUISIANA

PARISH OF ST. TAMMANY:

BEFORE ME, on May 16, 1990, the undersigned authority, personally came and appeared Jackie K. Fradella, who, being duly sworn, did depose and say that he signed this instrument as a witness, in the presence of the CITY and another subscribing witness, all of whom signed in his presence, each signing in the presence of all the other, and that all of the signatures are genuine.

WITNESSES:

Dianna D. Kroe

Jackie K. Fradella  
JACKIE K. FRADELLA

Elaine W. Guillot

Elaine W. Guillot  
ELAINE W. GUILLOT, Notary Public



GRANT OF DRAINAGE SERVITUDE

STATE OF LOUISIANA

BY: GEORGIA RAY THURMOND, wife of/and  
LOUIS P. LAGARDE, JR.

PARISH OF ST. TAMMANY

TO: CITY OF SLIDELL, LOUISIANA

KNOW ALL MEN BY THESE PRESENTS, THAT ON May 17, 1990,

GEORGIA RAY THURMOND, wife of/and and LOUIS P. LAGARDE, JR., both persons of the full age of majority, domiciled in the Parish of St. Tammany, State of Louisiana, (hereinafter referred to as OWNER),

and

CITY OF SLIDELL, LOUISIANA (hereinafter referred to as CITY), a Louisiana municipality, represented by Salvatore A. "Sam" Caruso, acting in his official capacity as Mayor, and specifically authorized by the Slidell City Council by Ordinance No. 2212 dated October 25, 1988, recorded in the official records of St. Tammany Parish in COB 1363, folio 925.

declare that OWNER does hereby grant to CITY, a RIGHT-OF-WAY approximately five (5) feet within which to construct, lay, maintain, inspect, operate, repair, alter, remove and relay drainage lines and canals and such drips, valves, fittings, meters, and other equipment and appurtenances as may be necessary or convenient for such operations across and under the following described property situated in the Parish of St. Tammany, State of Louisiana, to-wit:

All that certain parcel of land being designated as a 5' drainage easement situated on Lot 142, Fountain Estates Subdivision, Slidell, St. Tammany Parish, Louisiana, being more fully described as follows:

From the northeast corner of said Lot 142, which is the point of beginning, proceed 300°06'37"E 5.0 feet, thence S89°58'40"W 107.00 feet, then N00°06'37"W 5.0 feet, thence N89°58'40"W 112.5 feet to the point of beginning.

Together with all rights of ingress and egress to and from the line or lines, or any of them, for the purposes and benefits aforesaid. OWNER shall have the right to fully use them and enjoy the above described property, except as to the rights hereinabove granted. CITY hereby agrees and obligates itself to pay any damages which may occur to fences or buildings of the OWNER as a result of the exercise of the rights herein granted.

This servitude is made for and in consideration of the mutual benefits to be derived by the parties.

In witness whereof, the undersigned have set their names in the presence of the undersigned competent witnesses, who hereunto sign their names with the said appearers.

WITNESSES:

\_\_\_\_\_

*Georgia Ray Thurmond Lagarde*  
GEORGIA RAY THURMOND LAGARDE

*Louis P. Lagarde, Jr.*  
\_\_\_\_\_

LOUIS P. LAGARDE, JR.  
INSTR. # 761203  
ST. RES # 230241  
FILED ST. TAMMANY PAR  
31MAR 1990 100 TCE  
COB 1363 FOLIO 925  
#03 FOLIO

WITNESSES:

CITY OF SLIDELL

Jackie K. Fradella

BY: Salvatore A. Caruso  
SALVATORE A. "SAM" CARUSO  
MAYOR

STATE OF LOUISIANA

PARISH OF ST. TAMMANY

BEFORE ME, on May 14, 1990, the undersigned authority, personally came and appeared Dianna D. Knoll, who, being duly sworn, did depose and say that he signed this instrument as a witness, in the presence of OWNER and another subscribing witness, all of whom signed in his presence, each signing in the presence of all the other, and that all of the signatures are genuine.

WITNESSES:

Jackie K. Fradella  
Charlene Bacques

Dianna D. Knoll  
DIANNA D. KNOLL

Elaine W. Guellet  
Notary Public

STATE OF LOUISIANA

PARISH OF ST. TAMMANY:

BEFORE ME, on May 17, 1990, the undersigned authority, personally came and appeared Jackie K. Fradella, who, being duly sworn, did depose and say that he signed this instrument as a witness, in the presence of the CITY and another subscribing witness, all of whom signed in his presence, each signing in the presence of all the other, and that all of the signatures are genuine.

WITNESSES:

Jackie K. Fradella  
Charlene Bacques

Jackie K. Fradella  
JACKIE K. FRADELLA

Elaine W. Guellet  
ELAINE W. GUELLET, Notary Public





# The City of Slidell

SALVATORE A. "SAM" CARUSO, Mayor  
2055 Second Street • P. O. Box 828 • Slidell, Louisiana 70459  
Telephone (504) 646-4300

TO: Reinhard J. Dearing  
Forrest Koder  
Dianne Hanephin  
Davis Dautreuil ✓  
Stan Polivick

FROM: Jackie Fradella, Secretary to Elaine W. Guillot *JF*

DATE: June 4, 1990

SUBJECT: Grant of Servitude  
Charles C. Rush, Jr., et ux  
(Culvert Line Rehabilitation-Phase C)

Attached for your records is a copy of the above-referenced servitude which has been recorded with the Clerk of Court in Covington.

/jfk  
Attachment

GRANT OF DRAINAGE SERVITUDE

STATE OF LOUISIANA

BY: MARGARET GRANRUTH, wife of/and  
CHARLES C. RUSH, JR.

PARISH OF ST. TAMMANY

TO: CITY OF SLIDELL, LOUISIANA

KNOW ALL MEN BY THESE PRESENTS, THAT ON May 14, 1990,

MARGARET GRANRUTH, wife of/and CHARLES C. RUSH, JR.,  
both persons of the full age of majority, domiciled in the Parish  
of St. Tammany, State of Louisiana, (hereinafter referred to as  
OWNER),

and

CITY OF SLIDELL, LOUISIANA (hereinafter referred to as CITY),  
a Louisiana municipality, represented by Salvatore A. "Sam" Caruso,  
acting in his official capacity as Mayor, and specifically authorized  
by the Slidell City Council by Ordinance No. 2212 dated October 25,  
1988, recorded in the official records of St. Tammany Parish in  
COB 1363, folio 925.

declare that OWNER does hereby grant to CITY, a RIGHT-OF-WAY  
approximately five (5) feet within which to construct, lay,  
maintain, inspect, operate, repair, alter, remove and relay  
drainage lines and canals and such drips, valves, fittings,  
meters, and other equipment and appurtenances as may be necessary  
or convenient for such operations across and under the following  
described property situated in the Parish of St. Tammany, State of  
Louisiana, to-wit:

All that certain parcel of land being designated as a  
5' drainage easement situated on Lot 143, Fountain Estates  
Subdivision, Slidell, St. Tammany Parish, Louisiana, being  
more fully described as follows:

From the southeast corner of said Lot 143, which is the  
point of beginning, proceed N00°06'37"W 5.0 feet, thence  
S89°58'40"W 107.00 feet, then S00°06'37"E 5.0 feet, thence  
N89°58'40"E 107.0 feet to the point of beginning.

Together with all rights of ingress and egress to and from the  
line or lines, or any of them, for the purposes and benefits  
aforesaid. OWNER shall have the right to fully use them and  
enjoy the above described property, except as to the rights  
hereinabove granted. CITY hereby agrees and obligates itself  
to pay any damages which may occur to fences or buildings of  
the OWNER as a result of the exercise of the rights herein  
granted.

This servitude is made for and in consideration of the mutual  
benefits to be derived by the parties.

In witness whereof, the undersigned have set their names in the  
presence of the undersigned competent witnesses, who hereunto  
sign their names with the said appearers.

WITNESSES:

Jackie B. ...

Margaret Granruth Rush  
MARGARET GRANRUTH RUSH

Charles C. Rush, Jr.  
CHARLES C. RUSH, JR.

INSTR. # 750067  
ST. REC # 27835E  
FILED ST. TAMMANY PAR  
23MAY901014E TJE  
FOLIO 925  
MOF FOLIO



WITNESSES:

CITY OF SLIDELL

Jackie K. Fradella

BY: [Signature]

SALVATORE A. "SAM" CARUSO  
MAYOR

STATE OF LOUISIANA

PARISH OF ST. TAMMANY

BEFORE ME, on May 8, 1990, the undersigned authority, personally came and appeared Jackie K. Fradella, who, being duly sworn, did depose and say that he signed this instrument as a witness, in the presence of OWNER and another subscribing witness, all of whom signed in his presence, each signing in the presence of all the other, and that all of the signatures are genuine.

WITNESSES:

[Signature]

Jackie K. Fradella  
JACKIE K. FRADELLA

[Signature]

[Signature]  
Notary Public

STATE OF LOUISIANA

PARISH OF ST. TAMMANY:

BEFORE ME, on May 14, 1990, the undersigned authority, personally came and appeared Jackie K. Fradella, who, being duly sworn, did depose and say that he signed this instrument as a witness, in the presence of the CITY and another subscribing witness, all of whom signed in his presence, each signing in the presence of all the other, and that all of the signatures are genuine.

WITNESSES:

[Signature]

Jackie K. Fradella  
JACKIE K. FRADELLA

[Signature]

Elaine W. Guillot  
ELAINE W. GUILLOT, Notary Public





# The City of Slidell

SALVATORE A. "SAM" CARUSO, Mayor

2055 Second Street • P. O. Box 828 • Slidell, Louisiana 70459

Telephone (504) 646-4300

*Put in  
album  
file*

TO: Reinhard J. Dearing  
Forrest Koder  
Dianne Hanephin  
Davis Dautreuil ✓  
Stan Polivick

FROM: Jackie Fradella, Secretary to Elaine W. Guillot *JF*

DATE: September 20, 1989

SUBJECT: ~~Grant of Temporary Utility Servitude~~  
(Temporary Water Storage--MRO)  
~~My File: 2993.95~~

Attached for your records is a copy of the above-referenced Servitude which has been recorded with the Clerk of Court in Covington in COB 1398, folio 57.

/j kf  
Attachment:

cc: Richard E. Santora-w/enc.  
Scott T. Whittaker-w/enc.

GRANT OF TEMPORARY UTILITY SERVITUDE

STATE OF LOUISIANA

PARISH OF ST. TAMMANY

BY: 433 EXIT, INC.

TO: CITY OF SLIDELL, LOUISIANA

KNOW ALL MEN BY THESE PRESENTS, THAT ON September 8, 1989,

433 EXIT, INC., a Louisiana corporation herein represented by Angelo A. Paternostro, its President, duly authorized by virtue of a Resolution of the Board of Directors of said corporation, a copy of which is annexed hereto (hereinafter referred to as OWNER),

and

CITY OF SLIDELL, LOUISIANA (hereinafter referred to as CITY), a Louisiana municipality, represented by Salvatore A. "Sam" Caruso, acting in his official capacity as Mayor, and specifically authorized by the Slidell City Council by Ordinance No. 2212 dated October 25, 1988, recorded in the official records of St. Tammany Parish in COB 1363, folio 925.

declare that OWNER does hereby grant to CITY, a temporary servitude, approximately 7,171.85 square feet within which to construct, lay, maintain, inspect, operate, repair, alter, remove and relay utility lines and such drips, valves, fittings, meters, and other equipment and appurtenances as may be necessary or convenient for such operations across and under the following described property situated in the Parish of St. Tammany, State of Louisiana, to-wit:

ALL THAT CERTAIN PARCEL OF LAND being designated as a utility easement situated in Section 23, Township 9 South, Range 14 East, more fully described as follows:

From the section corner common to Sections 13, 14 and 24 of said Township and Range: Thence South 89 Degrees 42 minutes West-1320.00' to a point; Thence South 1,163.20' to a point; Thence South 1,087.64' to a point; Thence South 00 Degrees 11 minutes 20 seconds East-296.13' to a point; Thence South 00 Degrees 13 minutes 40 seconds West-89.23' to a point; Thence North 89 Degrees 58 minutes 18 seconds East-792.69' to a point; Thence South 00 Degrees 04 minutes 46 seconds East-545.49' to the point of beginning.

Thence South 00 Degrees 04 minutes 46 seconds East-581.27' to a point; Thence North 70 Degrees 03 minutes 18 seconds West-53.70' to a point; Thence North 19 Degrees 56 minutes 42 seconds East-37.58' to a point; Thence North 00 Degrees 04 minutes 46 seconds West-540.97' to a point; Thence South 71 Degrees 35 minutes 07 seconds East-10.54' to the point of beginning.

Containing 7,171.85' square feet of land.

Together with all rights of ingress and egress to and from the line or lines, or any of them, for the purposes and benefits aforesaid. OWNER shall have the right to fully use and enjoy the above described property, except as to the rights hereinabove granted. CITY hereby agrees and obligates itself to pay any damages which may occur to fences or buildings of the OWNER as a result of the exercise of the rights herein granted. CITY further agrees to indemnify and hold OWNER harmless from any claims for personal or property damage liability arising out of this grant of servitude, including all costs and attorney's fees incurred in connection therewith.

This temporary servitude shall expire upon completion by the CITY of a permanent water well or upon the expiration of two (2) years from the date of this agreement, whichever comes first.

This servitude is made for and in consideration of the mutual benefits to be derived by the parties.

In witness whereof, the undersigned have set their names in the presence of the undersigned competent witnesses, who hereunto sign their names with the said appearer.

WITNESSES:

433 EXIT, INC.

Cathy [Signature]  
Deaise L. Armstrong

BY: [Signature]  
ANGELO A. PATERNOSTRO  
President

WITNESSES:

CITY OF SLIDELL

[Signature]  
[Signature]

BY: [Signature]  
SALVATORE A. "SAM" CARUSO  
MAYOR

STATE OF LOUISIANA

PARISH OF ORLEANS

BEFORE ME, on September 1, 1989, the undersigned authority, personally came and appeared Deaise L. Armstrong, who, being duly sworn, did depose and say that she signed this instrument as a witness, in the presence of OWNER and another subscribing witness, all of whom signed in his presence, each signing in the presence of all the other, and that all of the signatures are genuine.

WITNESSES:

Cathy [Signature]  
[Signature]

Deaise L. Armstrong  
[Signature]  
Notary Public

STATE OF LOUISIANA

PARISH OF ST. TAMMANY:

BEFORE ME, on September 8, 1989, the undersigned authority, personally came and appeared BOB CALLAHAN, who, being duly sworn, did depose and say that he signed this instrument as a witness, in the presence of the CITY and another subscribing witness, all of whom signed in his presence, each signing in the presence of all the other, and that all of the signatures are genuine.

WITNESSES:

Diana [Signature]  
[Signature]

[Signature]  
Elaine W. Guillot  
Public

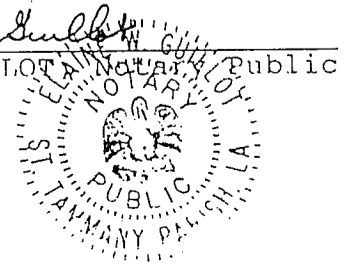

TO: CITY OF SLIDELL  
ATTACHMENT TO SKETCH 890,492

DATED: AUGUST 16, 1989  
7,171.85 SQ. FT. UTILITY EASEMENT

DESCRIPTION

All that certain parcel of land being designated as a utility easement situated in Section 23, Township 9 South, Range 14 East, more fully described as follows:

From the section corner common to Sections 13, 14, 23 and 24 of said Township and Range; Thence South 89 Degrees 42 minutes West-1320.00' to a point; Thence South 1,163.20' to a point; Thence South 1,087.64' to a point; Thence South 00 Degrees 11 minutes 20 seconds East-296.13' to a point; Thence South 00 Degrees 13 minutes 40 seconds West-89.23' to a point; Thence North 89 Degrees 58 minutes 18 seconds East-792.69' to a point; Thence South 00 Degrees 04 minutes 46 seconds East-545.49' to the point of beginning.

Thence South 00 Degrees 04 minutes 46 seconds East-581.27' to a point; Thence North 70 Degrees 03 minutes 18 seconds West-53.70' to a point; Thence North 19 Degrees 56 minutes 42 seconds East-37.58' to a point; Thence North 00 Degrees 04 minutes 46 seconds West-540.97' to a point, Thence South 71 Degrees 35 minutes 07 seconds East-10.54' to the point of beginning.

Containing 7,171.85' square feet of land.

PARCEL  
6-A

571°35'07"E  
10.54'

FROM THE SECTION CORNER COMMON  
TO SECTIONS 13, 14, 23 & 24 - T9S -  
R14E; THENCE S89°42'W - 1320.0';  
THENCE SOUTH - 1,163.20'; THENCE  
SOUTH - 1,087.64'; THENCE  
S00°11'20"E - 296.13'; THENCE  
S00°13'40"W - 89.23'; THENCE  
N89°58'18"E - 792.69'; THENCE  
S00°04'46"E - 545.49' TO  
THE POINT OF BEGINNING.

PROPOSED  
10' UTILITY  
EASEMENT

PARCEL 6-B

N00°04'46"W - 540.97'

S00°04'46"E - 561.27'

570°03'18"E  
29.36'

N19°56'42"E  
37.58'

7,171.85 SQ. FT.

N70°03'18"W  
53.70'

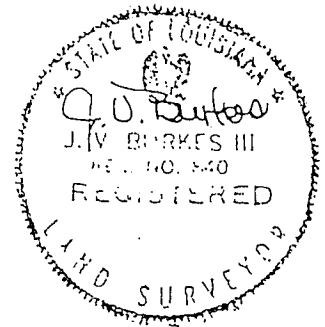

SKETCH OF  
A CERTAIN PARCEL OF LAND  
CERTIFIED TO  
SECTION 23 - T9S - R14E  
ST. TAMMANY PARISH, LA.  
FOR  
CITY OF SLIDELL

SCALE: 1"=100'  
DATE: AUG. 16, 1989  
JOB NO: 890, 492

PREPARED BY:  
J.V. BURKES & ASSOC., INC.  
P.O. BOX 1568  
SLIDELL, LA.



# The City of Slidell

SALVATORE A. "SAM" CARUSO, Mayor  
2055 Second Street • P. O. Box 828 • Slidell, Louisiana 70459  
Telephone (504) 646-4300

TO: Reinhard J. Dearing  
Forrest Koder  
Dianne Hanephin ✓  
Davis Dautreuil ✓  
Stan Polivick

FROM: Jackie Fradella, Secretary to Elaine W. Guillot *JF*

DATE: August 4, 1989

SUBJECT: Grant of Drainage Servitude by  
Joseph R. Capella, Sr., et ux

Attached for your records is a copy of the above-referenced Servitude which has been recorded with the Clerk of Court in Covington in COB 1393, folio 202.

/j kf  
Attachment

GRANT OF DRAINAGE SERVITUDE

STATE OF LOUISIANA

BY: DOROTHY LAGARDERE, wife of/and  
JOSEPH R. CAPELLA, SR.

PARISH OF ST. TAMMANY

TO: CITY OF SLIDELL, LOUISIANA

KNOW ALL MEN BY THESE PRESENTS, THAT ON July 24, 1989,

DOROTHY LAGARDERE, wife of/and JOSEPH R. CAPELLA, SR., both persons of the full age of majority, domiciled in the Parish of St. Tammany, State of Louisiana, (hereinafter referred to as OWNER),

and

CITY OF SLIDELL, LOUISIANA (hereinafter referred to as CITY), a Louisiana municipality, represented by Salvatore A. "Sam" Caruso, acting in his official capacity as Mayor, and specifically authorized by the Slidell City Council by Ordinance No. 2212 dated October 25, 1988, recorded in the official records of St. Tammany Parish in COB 1363, folio 925.

declare that OWNER does hereby grant to CITY, a servitude approximately eleven and one-half (11.5') feet within which to construct, lay, maintain, inspect, operate, repair, alter, remove and relay drainage lines and canals and such drips, valves, fittings, meters, and other equipment and appurtenances as may be necessary or convenient for such operations across and under the following described property situated in the Parish of St. Tammany, State of Louisiana, to-wit:

A certain piece of ground situated in Bayou Bonfouca Estates, Section 44, Township 9 South, Range 14 East, St. Tammany Parish, Slidell, Louisiana, being designated as Lot 48. Said portion of this lot being more fully described as follows:

Commencing from an iron found on the southeast corner of Lot 49 thence South 25 degrees 03 feet West, a distance of 50 feet to the point of beginning:

Thence North 25 degrees 57 feet West, a distance of + 130 feet to the edge of Bayou Bonfouca;

Thence South 37 degrees 03 feet West, a distance of 11.2 feet along waters edge;

Thence South 25 degrees 57 feet East, a distance of + 131.91 feet, to a point on the front property line of Lot 48;

Thence North 25 degrees 03 feet East, a distance of 12.2 feet to the point of beginning.

Encompassing a + 1,306.5 square feet (.03 acres).

Together with all rights of ingress and egress to and from the line or lines, or any of them, for the purposes and benefits aforesaid. OWNER shall have the right to fully use them and enjoy the above described property, except as to the rights hereinabove granted. CITY hereby agrees and obligates itself to pay any damages which may occur to fences or buildings of the OWNER as a result of the exercise of the rights herein granted.

This servitude is made for and in consideration of the mutual benefits to be derived by the parties.

INSTR. # 727107  
DT. REG # 240840  
FILED ST. TAMMANY PAR  
28 JUL 89 16:29 TET  
COB 1363 FOLIO 925  
NOB \_\_\_\_\_ FOLIO \_\_\_\_\_



In witness whereof, the undersigned have set their names in the presence of the undersigned competent witnesses, who hereunto sign their names with the said appearers.

WITNESSES:

Lloyd A. Capella  
LLOYD A. CAPELLA

Dorothy Lagardere Capella  
DOROTHY LAGARDERE CAPELLA

Jackie K. Fraedella  
JACKIE K. FRADELLA

Joseph R. Capella, Sr.  
JOSEPH R. CAPELLA, SR.

WITNESSES:

CITY OF SLIDELL

Jackie K. Fraedella  
JACKIE K. FRADELLA

BY: Salvatore A. "Sam" Caruso  
SALVATORE A. "SAM" CARUSO  
MAYOR

Dianna D. Knoll  
DIANNA D. KNOLL

STATE OF LOUISIANA

PARISH OF ST. TAMMANY

BEFORE ME, on July 17, 1989, the undersigned authority, personally came and appeared LLOYD A. CAPELLA, who, being duly sworn, did depose and say that he signed this instrument as a witness, in the presence of OWNER and another subscribing witness, all of whom signed in his presence, each signing in the presence of all the other, and that all of the signatures are genuine.

WITNESSES:

Jackie K. Fraedella  
JACKIE K. FRADELLA

Lloyd A. Capella  
LLOYD A. CAPELLA

Dianna D. Knoll  
DIANNA D. KNOLL

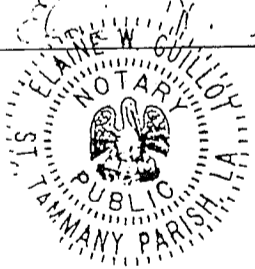
Elaine W. Guilloy  
Notary Public  

STATE OF LOUISIANA

PARISH OF ST. TAMMANY:

BEFORE ME, on July 24, 1989, the undersigned authority, personally came and appeared JACKIE K. FRADELLA, who, being duly sworn, did depose and say that he signed this instrument as a witness, in the presence of the CITY and another subscribing witness, all of whom signed in his presence, each signing in the presence of all the other, and that all of the signatures are genuine.

WITNESSES:

Dianna D. Knoll  
DIANNA D. KNOLL

Jackie K. Fraedella  
JACKIE K. FRADELLA

Jana B. Gross  
JANA B. GROSS

Elaine W. Guilloy  
Notary Public  

September 28, 1988

**PUBLIC NOTICE**

1. **Item No. 88-09-1292:** An ordinance rescinding and re-enacting Chapter 4 Animals and Fowl\* of the Code of Ordinances, of the City of Slidell.
2. **Item No. 88-09-1296:** An ordinance authorizing the Mayor or his designated representative to negotiate and acquire servitudes for public works projects.
3. **Item No. 88-09-1297:** An Ordinance rezoning a parcel of property located east of Voter's Road and north of the Ecol Gas Station and Old Spanish Trail, from C-4 Highway Commercial to C-6 Regional Shopping Center District, as petitioned by Mr. Angelo A. Paternostro.
4. **Item No. 88-09-1302:** An ordinance amending Chapter 9 Crimes - Miscellaneous, Section 9-57 Obstructing Public Passages, of the Code of Ordinances of the City of Slidell.

**NOTE:** A Public Hearing will be held on the above listed ordinances on Tuesday, October 25, 1988, at 6:30 P.M. in the Council Chambers.

These proposed ordinances are being printed by title only as required by Ordinance No. 1528.

CITY OF SLIDELL

Davis Dautreuil  
Council Administrator/Clerk of the Council

**PUBLISH DATE:** Tuesday, October 4, 1988