

1 Introduced August 12, 2014, by
2 Councilwoman Harbison, seconded by
3 Councilman Borchert, (by request of
4 Administration)

5 **RESOLUTION R14-20**

6
7 A resolution by the Slidell City Council supporting the application to the
8 Federal Highway Works Administration (FHWA) via the Louisiana Department of
9 Transportation and Development (LADTOD) for Transportation Alternative Program (TAP) for
10 funding to support "SPARTAN DRIVE MULTI-USE PATH" and assuming full responsibility
11 for the required local match and for managing and maintaining the project ("Project").

12 WHEREAS, the City of Slidell has a long standing goal to improve the
13 pedestrian and bicycle connectivity throughout the city, particularly between residential areas
14 and schools; and

15
16
17
18 WHEREAS, the main impediment to improved pedestrian and bicycle
19 connectivity is the lack of a safe route along Spartan Drive; and

20
21
22 WHEREAS, FWHA oversees a Transportation Alternatives Program (TAP)
23 which is not a grant but rather reimburses a City for authorized dollars spent, resulting in
24 a City budgeting for the total cost then submit for reimbursement for the 80%; and

25
26
27
28
29 WHEREAS, if the City of Slidell is selected, FHWA-TAP will provide 80%
30 cost share and the City would be responsible for 20% of the project plus all design,
31 engineering and inspection costs; and
32
33
34
35
36
37
38
39

1
2 **RESOLUTION R14-20**
3 **PAGE 2**

4 WHEREAS, based on cost estimates, the City would be responsible for
5
6 \$394,206.96. Additionally, the City would budget for the Federal Share of \$788,413.92,
7
8 which amount is reimbursable; and
9

10 WHEREAS, the Project will support other ongoing projects of the City
11
12 including, but not limited to, LADOTD's "US 11 ACCESS MANAGEMENT AND
13
14 COMPLETE STREET IMPROVEMENTS FROM SPARTAN DRIVE TO LA 433," which is
15
16 currently in the Stage 0 phase.
17

18 NOW THEREFORE BE IT RESOLVED by the Slidell City Council, Slidell,
19
20 Louisiana, in legal session convened, that the Council hereby recognizes and
21
22 acknowledges the City's responsibilities in connection with the Federal Highway Works
23
24 Administration via the Louisiana Department of Transportation and Development for
25
26 Transportation Alternative Program to support "SPARTAN DRIVE MULTI-USE PATH," which
27
28 consist of the City's responsibility for 20% of the project plus all design, engineering and
29
30 inspection costs; that TAP is not a grant but rather reimburses the City for authorized
31
32 dollars spent; and that the City will budget for the total cost and make submittals for
33
34 reimbursement for 80% of same.
35

36
37 BE IT FINALLY RESOLVED that the Slidell City Council, Slidell, Louisiana,
38
39 hereby supports the application to the FHWA via LADOTD for TAP funding to support a

1
2 **RESOLUTION R14-20**
3 **PAGE 3**

4 "SPARTAN DRIVE MULTI-USE PATH" project.
5
6
7

8 **ADOPTED** this 12th day of August, 2014.

9
10 
11 Kim Harbison
12 President of the Council
13 Councilwoman-at-Large

14 
15 Thomas P. Reeves
16 Council Administrator
17
18
19
20
21
22
23
24
25
26
27
28
29
30
31
32
33
34
35
36
37
38
39

Louisiana Department of Transportation and Development
2014 APPLICATION FOR FEDERAL PROGRAMS

Program

- Check DOTD Transportation Alternatives Program
- Check Recreational Trails
- Check Local Roads Safety Program
- Check Safe Routes to School

General information to be completed for all programs.

SPONSOR INFORMATION

Entity Name City of Slidell

Type of Sponsor

- Check Public University/School
- Check State Government
- Check Other: _____
- Check Federal Agency
- Check Non-profit
- Check Local Government
- Check Partnership (if more than 1 explain)

Address P.O. Box 828

City Slidell State LA Zip (9 digits) 70459

Contact Person (Signatory) Freddy Drennan Title Mayor

Contact Person (Responsible Charge) Donna O'Dell Title City Engineer

Email dodell@cityofslidell.org Phone # 985-646-4270

Fax # 985-646-6124 DUNS # 20855748

Vendor # _____ Federal ID 726001341

CONSULTANT INFORMATION

If known, please provide consultant information. Please note that companies that are on DOTD's disqualified or disbarred list cannot be used on Federal Aid projects. The lists may be found by going to www.dotd.la.gov. Go to "Doing Business with DOTD"/"Consultant Contract Services"/"Solicitation Information"

Name of Company _____

Address _____

State _____ Zip _____ Contact Person _____

Title _____ Phone Number _____

Email _____ FAX Number _____

BRIEF PROJECT INFORMATION

Name of project Spartan Drive Multi-Use Path

Roadway or Facility Name (If different from project name) Spartan Drive

Brief Project Description

7,000 feet of a multi-use path from Fritchie Park to Hwy 11 along Spartan Drive

Length with Project Beginning & Ending Points (If applicable) 7,000 feet

GPS Coordinates Latitude: 30.244627 Longitude: -89.772831

Project Location (Attach Map) Parish(es) St. Tammany

State House District No. 76 State Senate District No. 1

What is the type of land use adjacent to the project? (Residential, Commercial, Agricultural, School, Government, etc.)
Government

Are there any drainage issues or features associated with the property site location? Please explain
No

GENERAL INFORMATION

Priority (Relative to other applications submitted by Project Sponsor this cycle)	High	
	YES	NO
Does this project require professional design services?	<input checked="" type="checkbox"/>	<input type="checkbox"/>
Is Sponsor providing funding for required match?	<input checked="" type="checkbox"/>	<input type="checkbox"/>
Will additional funding be provided over required match? If yes, how much?	<input type="checkbox"/>	<input checked="" type="checkbox"/>
Is this project a continuation of a phase project? Which phase of Series? State Project No/Names of other phases:	<input type="checkbox"/>	<input checked="" type="checkbox"/>
For Metropolitan Areas over 50,000 population, has the Metropolitan Planning Organization (MPO) endorsed the project? (Provide letter of MPO endorsement)	<input type="checkbox"/>	<input checked="" type="checkbox"/>
For areas under 50,000, is the project endorsed by the local government?	<input checked="" type="checkbox"/>	<input type="checkbox"/>
Does all right-of-way necessary for the project fall within public ownership or lease? If yes, was right-of-way obtained using federal guidelines? If no, can the sponsor obtain the property (or 25 year lease within 1 year of acceptance into the programin - program specific) in accordance with the Federal Uniform Act	<input checked="" type="checkbox"/> <input checked="" type="checkbox"/> <input type="checkbox"/>	<input type="checkbox"/> <input type="checkbox"/> <input type="checkbox"/>
Will all of the project be constructed within State-Maintained right-of-way?	<input type="checkbox"/>	<input checked="" type="checkbox"/>
If not all, will any of the project be constructed within State-Maintained right-of-way?	<input type="checkbox"/>	<input checked="" type="checkbox"/>
Does any part of the project encroach on or cross railroad right-of-way? If yes, attach a document from the affected railroad stating they are aware of the project	<input type="checkbox"/>	<input checked="" type="checkbox"/>
Is the sponsor aware that the project must conform to applicable requirements of the Americans with Disabilities Act or any other state or federal laws concerning accessibility?	<input checked="" type="checkbox"/>	<input type="checkbox"/>
Will this project serve a low-income community?	<input type="checkbox"/>	<input checked="" type="checkbox"/>
Will this project serve minorities (Black, Hispanic, Asian and Pacific Islander, American Indian or Alaskan Native)?	<input checked="" type="checkbox"/>	<input type="checkbox"/>
Will this project serve senior citizens (age 65 or older)?	<input checked="" type="checkbox"/>	<input type="checkbox"/>
Will this project serve those physically challenged (disabled, handicap, etc.)?	<input checked="" type="checkbox"/>	<input type="checkbox"/>

DETAILED PROJECT DESCRIPTION

Describe all work necessary for the project. If the project is to be phased, first give overall description of entire project with cost, then detail items for which funding is sought. Description should reflect only activities checked under project category and limited to the space provided.

Project consists of design of 7,000 feet of Multi-Use Path along Spartan Drive from Fritchie Park to Hwy 11. Project will also consist of construction of the Multi-Use Path. Included is a cost breakdown of items and quantities needed in order to construct the Multi-Use Path.

MAPS, PLANS & PHOTOGRAPHS

Attach project location map(s); project boundary map and site plan (if available). Include photographs of the existing site and/or facility if applicable. Please note this application will be reproduced, so please provide maps in a "reproducible friendly" format (on 8-1/2" X 11" paper. No Polaroid pictures please). Comments on the projects should be outlined in the space provided.

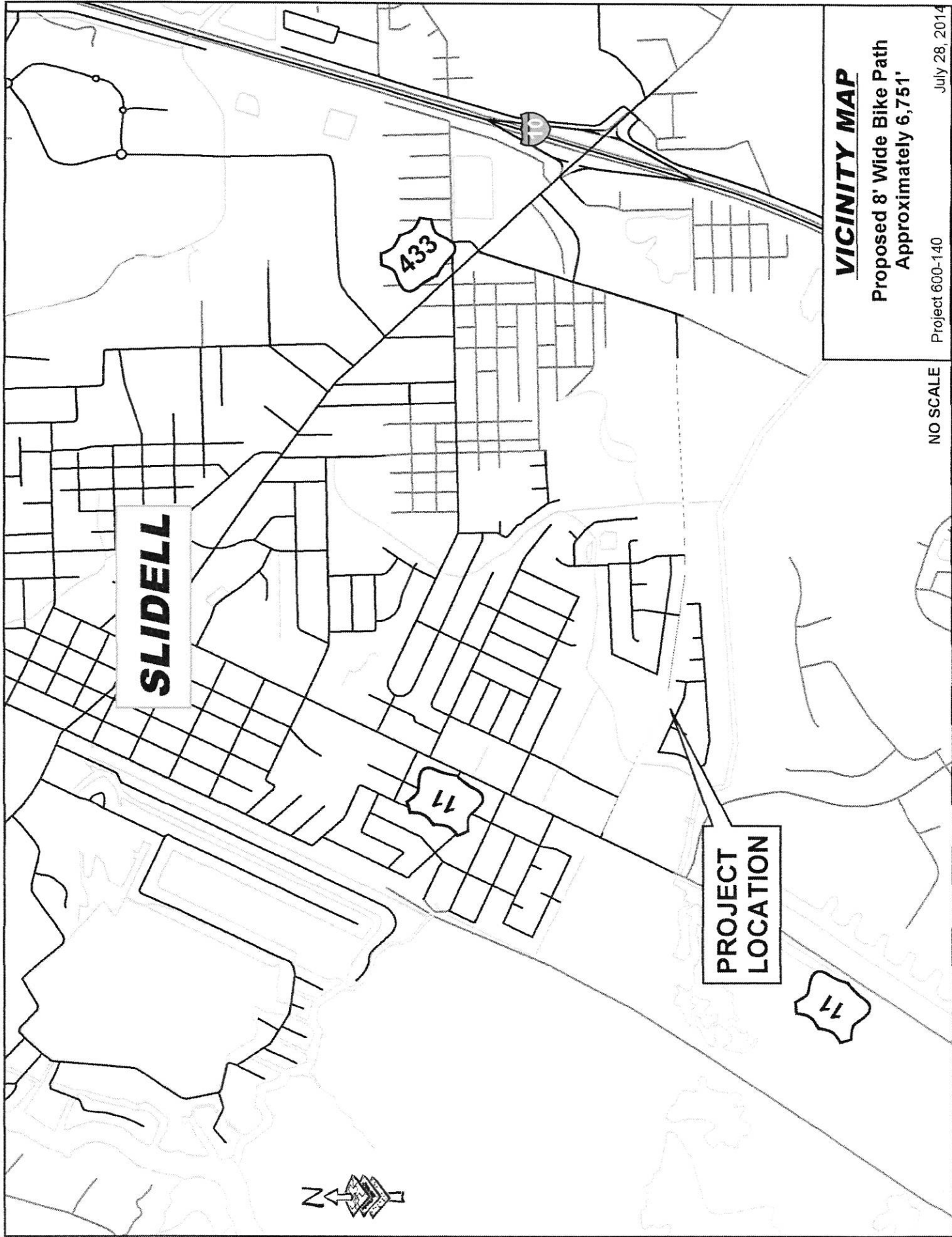

SLIDELL

**PROJECT
LOCATION**

VICINITY MAP

Proposed 8' Wide Bike Path
Approximately 6,751'

Project 600-140

NO SCALE

July 28, 2014

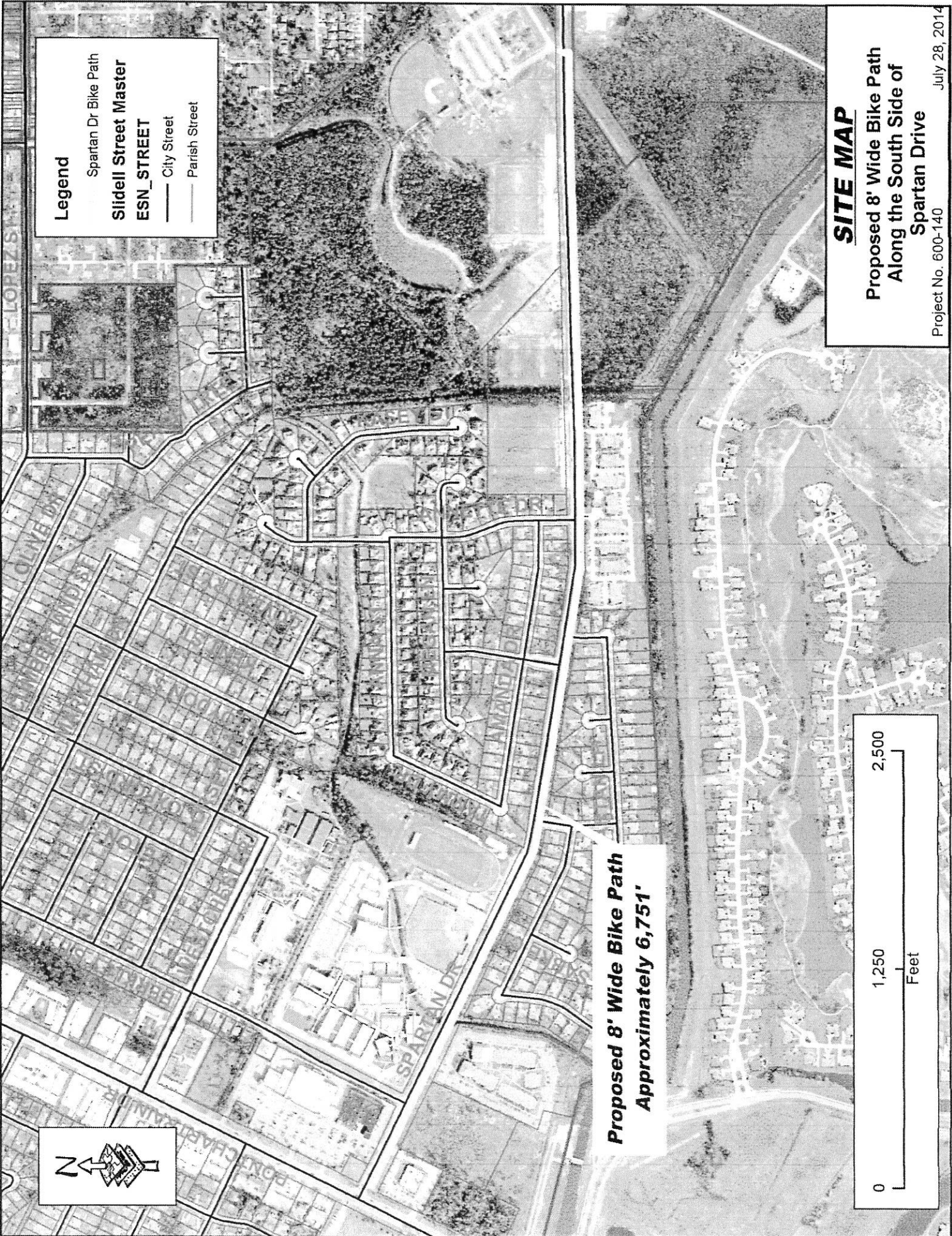

Legend

Spartan Dr. Bike Path

Slidell Street Master

ESN STREET

City Street

Parish Street

SITE MAP

**Proposed 8' Wide Bike Path
Along the South Side of
Spartan Drive**

Project No. 600-140

July 28, 2014

**Proposed 8' Wide Bike Path
Approximately 6,751'**



PROJECT BENEFITS

Please indicate in the space provided how the project benefits the state and/or community. Examples include economic, quality of life, quality of transportation, and quality of environment. If project benefits safety of pedestrians, bicyclists, and/or motorists, please include information on applicable accident and/or fatality information/records. If project provides access to schools, please show location of school to the project on the location map. Though attachments may be included, "See attached" for project benefits description is NOT acceptable.

The project benefits the community of Slidell by providing an easily accesible route to bring pedestrians to one of Slidell's public parks. Spartan Drive is a roadway in Slideell that experiences a heavy volume of traffic. A recent traffic study shows that the average daily traffic volume to be over 4,000 vehicles. The Multi-Use Path will provide a safe route for pedestrians and bicyclists to access Spartan Drive. The Multi-Use Path will also serve as a route for students to access Salmen High School, a local public school in Slidell.

IMPLEMENTATION

Explain how you plan to implement your project (include anticipated start date, design date, implementation timeframe, completion date and any anticipated "hold-ups"). Please note that it is a program policy, that if a project has not shown significant progress (as determined by the Program Manager) 3 years after inclusion into the program, the project will be cancelled.

Announce receipt of grant	1/1/2015
Procurement of Engineering Services	90 days
Completion of Design	120 days
Bid Proposal and Procurement	60 days
Permitting and Contracting	60 days
Construction of Multi Use Path	90 days
Conduct Project Closeout	30 days

PROJECT COST

Itemize ALL project elements and costs for which funding is being sought. All construction contracts will be advertised and bid by DOTD, take this into consideration when preparing project costs. List item, description, quantity, unit price, amount, etc. Include items for mobilization, temporary signs and barricades, and construction layout (if layout is applicable and to be performed by contractor). Be sure to have as complete and accurate a cost estimate as possible for all phases of the work and consider inflationary costs due to time in the program.

Construction Costs				
DOTD ITEM NUMBERS	UNIT OF MEASURE	QUANTITY (A)	UNIT PRICE (B)	AMOUNT (A*B)
201-01-00100	LS	1	\$ 60,000.00	\$ 60,000.00
203-01-00100	CY	4500	\$ 10.00	\$ 45,000.00
203-07-00100	CY	6800	\$ 20.00	\$ 136,000.00
204-02-00100	EA	10	\$ 20.00	\$ 200.00
204-06-00100	LF	14000	\$ 2.50	\$ 35,000.00
302-01-00800	CY	4000	\$ 25.00	\$ 100,000.00
502-01-00100	Ton	700	\$ 150.00	\$ 105,000.00
701-07-00200	LF	2100	\$ 20.00	\$ 42,000.00
713-01-00100	LS	1	\$ 1,000.00	\$ 1,000.00
717-01-00100	pound	200	\$ 20.00	\$ 4,000.00
718-01-00100	pound	4000	\$ 1.00	\$ 4,000.00
726-01-00100	CY	50	\$ 40.00	\$ 2,000.00
729-01-00100	SF	17	\$ 25.00	\$ 425.00
729-21-00100	EA	8	\$ 150.00	\$ 1,200.00
NS-ENH-02100	EA	4	\$ 550.00	\$ 2,200.00
NS-ENH-16040	LS	2	\$ 150,000.00	\$ 300,000.00
Subtotal				\$ 838,025.00
Mobilization (5-10% of Amount Subtotal)		1	\$ 83,802.50	
Traffic Control (2-10% of Amount Subtotal)		1	\$ 16,760.50	
Construction Layout (0-5% of Amount Subtotal)		1	\$ 5,028.15	
Contingencies (0-10% of Amount Subtotal)		1	\$ 41,901.25	
CONSTRUCTION COSTS TOTAL				\$ 985,517.40

Engineering Costs		
Engineering Design and CEI	For estimating purposes, use minimum 20% of Construction Costs for Projects > \$100,000; use minimum 40% for Projects < \$100,000	\$ 197,103.48
ENGINEERING COSTS TOTAL		\$ 197,103.48

Other Costs			
Right-of-way	1	\$ -	
Utility Relocation	1	\$ -	
Miscellaneous	1	\$ -	
OTHER COSTS TOTAL			\$ -

Total Project Costs (Construction + Engineering + Other)	\$ 1,182,620.88
Total Project Costs Eligible for Disbursement	\$ 985,517.40
Federal Participation/Local Match (show as %, ex. 90/10)	80/20
Total Requested Federal Funds	\$ 788,413.92
Local Match	\$ 197,103.48

OPERATION AND MAINTENANCE COSTS

Briefly describe the Maintenance and Operating Plan for this project. Include an estimate of the annual cost of maintenance and operation including the source of those funds. For projects with landscaping and/or electrical systems, a formal operation and maintenance report will be required at the final plan submittal.

Maintenance and Operating the Multi-Use Path will fall under the authority of the City of Slidell Recreation Department. All costs associated with maintaining the Multi-Use Path will come from the budget of the Recreation Department.

Program Specific

SUPPORTING DOCUMENTATION

DOTDTAP Projects

Eligibility Criteria

Checking all categories possible does not ensure or increase eligibility. Each criteria checked must meet all criteria listed for that activity in the DOTDTAP Information Guide

Project Category (Check only those activities that will be funded with DOTDTAP funds)

- Pedestrian And Bicycle Facilities (A1)
- Safe Routes For Non-Drivers (A2)
- Conversion Of Abandoned Railway Corridors To Trails (A3)
- Scenic Turnouts, Overlooks And Viewing Areas (A4)
- Outdoor Advertising Management (A5)
- Historic Preservation & Rehab Of Historic Transportation Facilities (A6)
- Vegetation Management (A7)
- Archaeological Activities (A8)
- Stormwater Mitigation (A9)
- Wildlife Management (A10)

Other Considerations for Eligibility

	YES	NO
If the project involves landscaping activities on State-Maintained Highway right-of-way, has the project been discussed with the DOTD District Operations Engineer?	<input type="checkbox"/>	<input checked="" type="checkbox"/>
If the project involves Category A4 (Scenic Turnouts, etc) along a designated Louisiana byway, has a letter of no objection been obtained from the Louisiana Byways Manager at DCRT? If yes, attach copy.	<input type="checkbox"/>	<input type="checkbox"/>
If the project involves Category A6 (Historic Preservation, etc), is the property listed on the National Register of Historic Places? If not registered, has registered been applied for?	<input type="checkbox"/>	<input type="checkbox"/>
If the project involves piping a ditch (subsurface drainage) that is over 50% of the overall project cost, has there been reported vehicular/pedestrian incidents? If so please provide reports. If no incidents, is the sponsor aware that the remaining 50% is a local cost?	<input type="checkbox"/>	<input type="checkbox"/>

FEDERAL COST SHARE REQUESTED, LOCAL FUNDING AND SOURCE

Line 1-Total project cost	\$	\$	985,517.40
Line 2-Local funding (minimum 20% of project costs)	\$	\$	197,103.48
LIST OF SOURCES OF LOCAL FUNDING			AMOUNT
A- City funded Capital Budget	\$	\$	197,103.48
B-	\$		
C-	\$		
D-	\$		
TOTAL AMOUNT OF LOCAL FUNDING (Should be equal to Line #2 above)	\$	\$	197,103.48
Line 7-Federal Cost Share Requested for Project (Subtract Line 2 from Line 1, Round to nearest \$100)	\$	\$	788,413.92

CERTIFICATION

The undersigned has authority to sign on behalf of the Sponsor and certifies that the undersigned has legal authority to enter into a contract to implement this project. The undersigned certifies that all information provided is complete and accurate to their best knowledge. The undersigned acknowledges that if the project is accepted into an LPA program that funding and scope of work requested in this application shall not be changed from that originally requested without approval by LaDOTD. Any additional costs will be borne by the Sponsor.



Signature

7/28/2014

Date

Mayor

985-646-4333

Title

Phone Number

Freddy Drennan

Printed Name