

Olde Towne Slidell Community Christmas Golf Cart Parade
2023 Parade Registration Form
Saturday, December 2, 5 p.m.

NAME: _____

Number of Golf Carts in Party: _____
(if applicable)

EMAIL: _____ PHONE: _____

Schedule of Parade Events:

3:00 – 4:00 p.m. Arrival and Check-in (see map)
4:00 – 4:45 p.m. Parade line up (see map)
5:00 p.m. Parade starts

- Please return completed Parade Registration Forms to the Department of Cultural & Public Affairs by Monday, Nov. 27, by emailing CulturalAffairs@cityofslidell.org or mailing to PO Box 828, Slidell, LA 70459.
- For public safety issues, the size of tires on golf carts must not exceed 14-inches in diameter.
- Space is limited to the first 100 golf carts to submit their registration forms. Late entries will not be accepted.
- Once your Parade Registration Form is submitted, you will be assigned a numbered Parade Pass. This Parade Pass will be presented at the Parade Sign-in on Dec. 2 and must be displayed on the vehicle. Vehicles without a Parade Pass will not be allowed to participate.
- Golf carts should be decorated and illuminated with Christmas lights.
- Participants are encouraged to throw individually wrapped candy. Beads, plastic cups, stuffed animals, plastic toys and other items are allowed, but do not throw anything with hard edges or sharp points.
- No lewd or profane costumes, decorations, music, language, or throws will be allowed.
- Questions? Please contact the Department of Cultural & Public Affairs at (985) 646-4375 or email CulturalAffairs@cityofslidell.org.

SIGNATURE: _____ DATE: _____

Please return this completed form to CulturalAffairs@cityofslidell.org or mail to
Dept. of Cultural & Public Affairs, PO Box 828, Slidell, LA 70459, by Monday, Nov. 27.

Olde Town Slidell

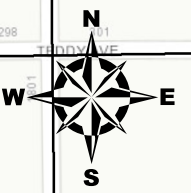

- No Parking Zone 3PM - 8PM
- Barricades and Bollards
- Golf Cart Trailer Parking
- Parade Lineup
- Parade Route

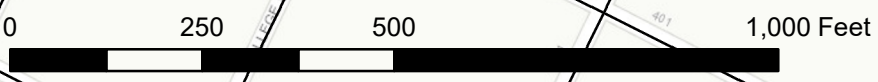

Sources: Esri, HERE, Garmin, Intermap, increment P Corp., GEBCO, USGS, FAO, NPS, NRCAN, GeoBase, IGN, Kadaster NL, Ordnance Survey, Esri Japan, METI, Esri China (Hong Kong), (c) OpenStreetMap contributors, and the GIS User Community